

For a Free Quote:

Web: EnergyPal.com/solar

Call: 1-800-990-3725

Email: contact@energypal.com

EnergyPal

Solar Panel Guide Specification Data Sheet

**CECEP Solar Energy Technology (Zhenjiang) Co.,
Ltd.**

**CEC6-4-72PA
CEC6-4-72-325PA**

Also available on the web at
EnergyPal.com/cecep-solar-energy-technology-zhenjiang-co-ltd-solar-panels/cec6-4-72-325pa

Polycrystalline Solar Modules



CEC6-4-72PA

300~325W
POWER OUTPUT RANGE

15.5%~16.7%
MODULE EFFICIENCY

+1~+6W
POWER TOLERANCE

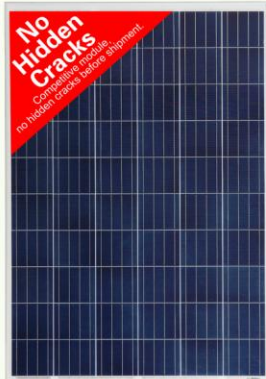

CECEP Solar Energy Technology(Zhenjiang) Co., Ltd. was established in August 2010, and the registered capital of the company reaches 351 million RMB.As one of the central Government-led Enterprise, it is a subsidiary of CECEP Solar Energy Technology Co.,Ltd.. Main business is the research, manufacture and sale of crystalline silicon solar cells and modules.

中节能太阳能科技（镇江）有限公司
CECEP Solar Energy Technology(zhenjiang) Co.,Ltd.

ADD: No.9,Beishan Road,New District,
Zhenjiang,jiangsu,China 212132
Tel: +86-511-8559 7760
Fax: +86-511-8558 7711
Web: www.cecepsolar.com
Stock code: SZ000591 太阳能



汇聚光伏能源，建设绿色家园/Converging PV Energy, Creating Green Homeworld

Product Features

- Module can withstand the snow pressure up to 5400Pa; Module can withstand wind pressure up to 2400Pa;
- +6W** Guaranteed power output +1~+6W;
- In weak light conditions (cloudy weather and morning and evening)with a high-performance;
- Independently certified by international certification bodies,including the IEC61215,IEC61730,UL1703, TUV Safety Class II, the CE;
- ISO** ISO9001 and ISO14001,OHSAS18001 international standards,quality, environment , vocational health managing system.

Quality Warranty

- 10 years process performance guarantee;
- Output power no less than 90% after 12 years;
- Output power no less than 80% after 25 years;

Linear Performance Warranty

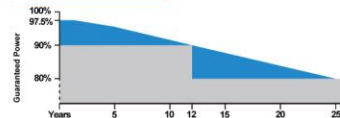

Certifications



Module Parameter

Electrical Characteristics	CEC6-4-72-300PA	CEC6-4-72-305PA	CEC6-4-72-310PA	CEC6-4-72-315PA	CEC6-4-72-320PA	CEC6-4-72-325PA
Max Power (Wp)	300	305	310	315	320	325
Max-Power Voltage Vmp (V)	36.50	36.90	37.13	37.20	37.30	37.50
Max-Power Current Imp (A)	8.22	8.27	8.35	8.47	8.58	8.67
Open-Circuit Voltage Voc (V)	45.10	45.30	45.60	45.9	46.2	46.5
Short-Circuit Current Isc (A)	8.69	8.75	8.85	8.95	9.10	9.17
Max-system Voltage Vdc (V)	1000	1000	1000	1000	1000	1000
Power Tolerance (W)	+1~+6	+1~+6	+1~+6	+1~+6	+1~+6	+1~+6

All specified Parameters are at STC 25°C,1000W/m² irradiance and AM1.5

Physical Parameter

Cell Size	156×156mm,72pcs,Polycrystalline Silicon(6×12)
Glass Type and Thickness	High Transmission,Low Iron, Tempered Glass 3.2mm
Frame & No of waterpout	Anodised aluminium & 20
Junction Box	IP 67 rated

Temperature Coefficient

NOCT Nominal Operating Cell Temperature(NOCT)	47°C±2°C
Temperature coefficient of P _{max}	-0.43%/°C
Temperature coefficient of V _{oc}	-0.33%/°C
Temperature coefficient of I _{sc}	0.04%/°C

Mechanical Characteristics

Dimension	1957×992×40×35mm
Mounting hole size	800×942,1300×942mm
Cable Length	900mm
Weight	22kg

Packaging Configuration

Pieces per case	24 pcs/case
Quantity per pallet	2 case/pallet
Pieces per container	576 pcs/40 GP

Technical Drawings

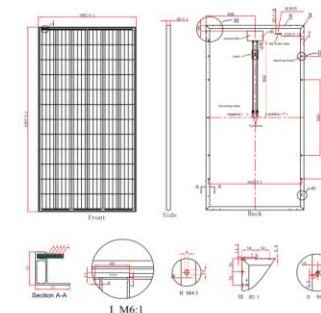

I-V Curve (320W)

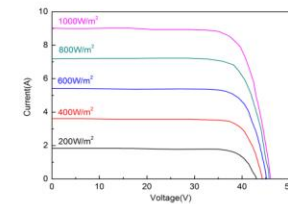

CECEP Solar Energy Technology(Zhenjiang)Co.,Ltd.
Sales Hotline: +86-511-85597760 Sales E-mail: marketing@cecec.com
www.cecepsolar.com

Proclamation: The company reserves the final right for explanation on any of the information presented. Their data sheet specifications are subject to change without prior notice.
APRIL 2016 EDITION