

**For a Free Quote:**

**Web: [EnergyPal.com/solar](http://EnergyPal.com/solar)**

**Call: 1-800-990-3725**

**Email: [contact@energypal.com](mailto:contact@energypal.com)**

# **EnergyPal**

## **Solar Panel Guide Specification Data Sheet**

**Interplex Solar Inc**

**ISP-A150**

**ISP-A150**

Also available on the web at  
[EnergyPal.com/interplex-solar-inc-solar-panels/isp-a150](http://EnergyPal.com/interplex-solar-inc-solar-panels/isp-a150)

# ISP-A150 Panels Specifications

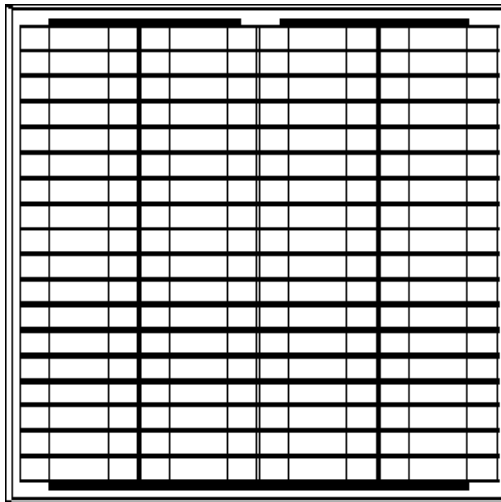

**Laminate:** Glass /EVA / TPT

(tedlar/pet/tedlar) or TPE **Front Side:**

High-transmission 3.2mm tempered glass

**Back Side:** TPT /TPE

**Frame:** Clear anodized aluminum frame

**Output :**  
Junction  
box

Module Type	Pm(Wp)±5%	Vmpp(V)	Imp(A)	Voc(V)	Isc(A)	Module size	NET(kg)
ISP-A150	50	17.3	2.89	21.6	3.21	650*670*35(mm) 25.6*26.4*1.38(inch)	5.1

**Operation Temperature Range:** - 40°C ~ 85°C

**NOCT:** 48°C±3°C

**Temperature coefficients of Im:**

+ 0.1 %/°C Temperature

**coefficients of Vm:** - 0.38 %/°C

**Maximum System Voltage:**

DC715V

**STC:** 1000W/m<sup>2</sup> , 25°C , AM1.5

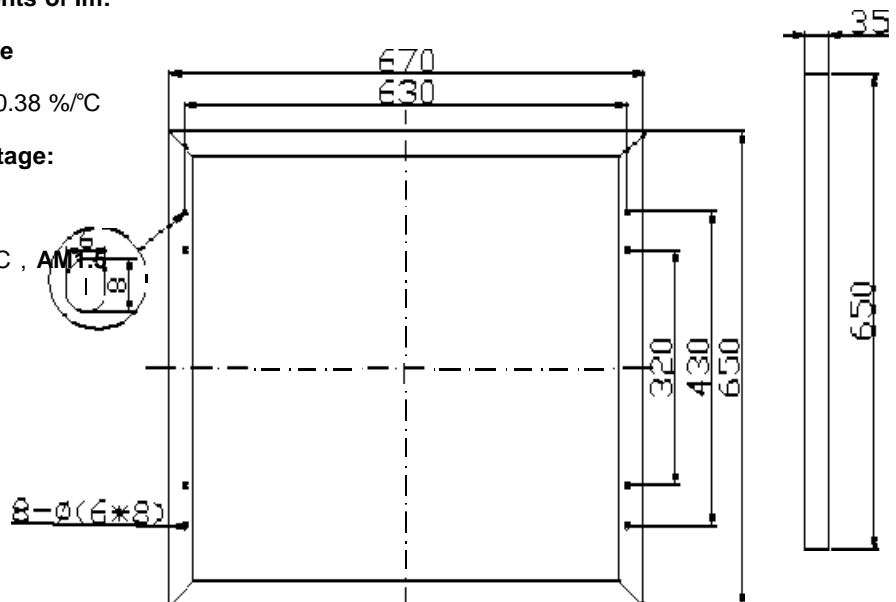

All the data of this sheet are subjected to change without notice.