

For a Free Quote:

Web: EnergyPal.com/solar

Call: 1-800-990-3725

Email: contact@energypal.com

EnergyPal

Solar Panel Guide Specification Data Sheet

Zhejiang Kingdom Solar Energy Technic Co., Ltd.

KD -M205-220

KD-M220

Also available on the web at

EnergyPal.com/zhejiang-kingdom-solar-energy-technic-co-ltd-solar-panels/kd-m220

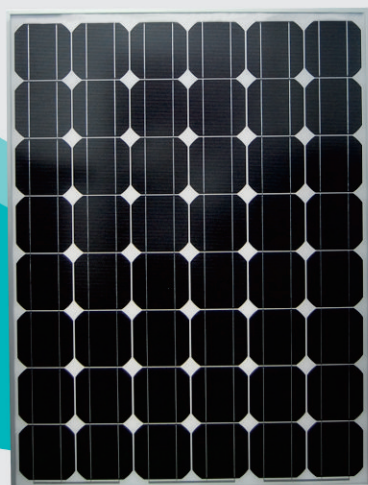

高质量太阳能组件 High Quality Solar Panel KD-M205W--220W

型号 Module type:

KD-M205W, KM-M210W, KD-M215W,
KD-M220W

装柜量 Packing Configuration	30mm边框 30mmFrame		
Container 集装箱	20FT	40GP	40HQ
Pieces per pallet 每托盘数量	70	70	78
Pallets per container 每集装箱托盘数	8	16	16
Pieces per container 每集装箱数量	560	1120	1248

组件最高功率 Highest module efficiency:

16.77%



正公差
Positive tolerance offer:0-+5w

材料和工艺质保 Material & Workmanship warranty:

10 year



欧洲大银行能接受
TUV bankable in all European big banks

输出功率保证 Linear power output warranty:

25 year



证书能承受风速(2400 pa)和机械负载(5400 pa)
Certificated to withstand wind (2400pa) and mechanical load (5400pa)

ZHEJIANG KINGDOM SOLAR ENERGY TECHNIC CO.,LTD
Tel: 0086-576-85508111 Fax: 0086-576-85178266
Website: <http://www.kingdomsolar.net>

Address: Huifeng North Road, Jiangnan Development Area,
Linhai, Zhejiang, China

E-mail:
kingdom@kingdomsolar.net
panel@kingdomsolar.net
technic@kingdomsolar.net
kdomsolar@kingdomsolar.net
solar@kingdomsolar.net
poly@kingdomsolar.net
power@kingdomsolar.net
energy@kingdomsolar.net
solarpanel@kingdomsolar.net
kdm@kingdomsolar.net

规格 Specifications

Type 型号	KD-M205	KD-M210	KD-M215	KD-M220
Wattage(w) 瓦数	205	210	215	220
Open Circuit Voltage (V) 开路电压	30.6	31.3	31.3	31.3
Short circuit Current (I) 闭路电流	8.94	8.97	9.1	9.2
Maximum Power Voltage (V) 最大输出电压	24.3	24.8	24.8	24.8
Maximum Power Current (I) 最大输出电流	8.44	8.47	8.67	8.87
Cell Efficiency (%) 电池片效率	18.50%	18.90%	19.40%	19.80%
Module Efficiency (%) 组件效率	15.67%	16.01%	16.43%	16.77%
Maximum System Voltage (V) 最大系统电压	DC1000V			
Temperature Coefficient of Voc VOC温度系数	-0.270%/°C			
Temperature Coefficient of Isc Isc温度系数	+0.045%/°C			
Temperature Coefficient of Pmax Pmax温度系数	-0.408%/°C			
Maximum Series Fuse Rating最大串联保险丝额定电流(A)	10A			
Number of Cells 电池片数量	6x8(156mmx156mm)			
Junction Box 接线盒	with 2bypass diodes			
Cable 电缆	Length 900mm,4mm ²			
Tempered Glass 钢化玻璃	3.2mm(0.13 inches)tempered glass 3.2mm (0.13 英寸)钢化玻璃			
Cell Encapsulation 电池片封装	EVA (Ethylene-Vinyl-Acetate)			
Back Sheet 背板	Triple-layer 三层			
Frame 边框	Anodized aluminum alloy 铝合金			
Dimension 尺寸	1324x992x30mm(52.12x39.05x1.18inches)			
Maximum Surface Load Capacity 最大表面负荷	5400Pa			
Hail撞击	steel ball fall down from 1m height 钢球从1米高度跌落			
Temperature Range 温度范围	-40°C to +85°C			
Weight 重量	14.0Kg(30.9lbs)			

物理特性 单位:毫米(英寸) PHYSICAL CHARACTERISTICS Unit:mm(inch)

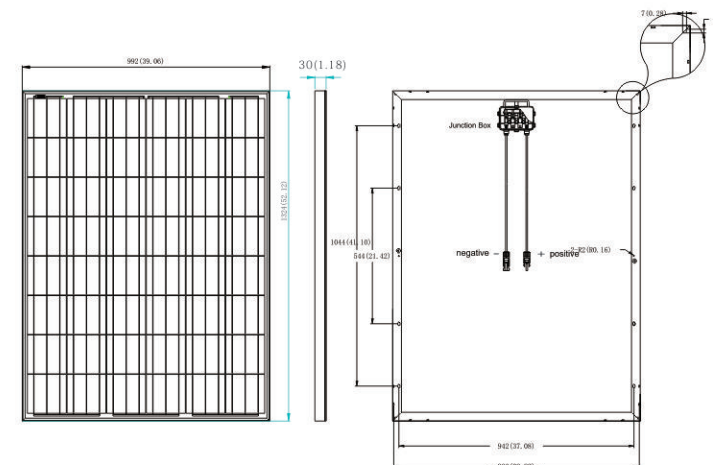

电气参数 ELECTRICAL CHARACTERISTICS

电气性能(组件温度:25°C)
Electrical performance (cell temperature:25°C)

