

For a Free Quote:

Web: EnergyPal.com/solar

Call: 1-800-990-3725

Email: contact@energypal.com

EnergyPal

Solar Panel Guide Specification Data Sheet

King-PV Technology Co., Ltd.

KPV275P-60

KPV250P-60

Also available on the web at
EnergyPal.com/king-pv-technology-co-ltd-solar-panels/kpv250p-60

KPV275P-60
250-275W Poly solar panel
 多晶硅太阳能组件
 TUV、CE、ISO、
 CQC等产品认证



Characteristics (特征)



4 Busbar solar cell(4主栅光伏电池片):
 With excellent current collection capability, decreasing consumption of current during current passing through solar cell, offer a better appearance, making it perfect for rooftop installation. (更加均匀的电流收集能力, 降低电池片的电流内损耗, 外形美观, 更加适合民房安装)



High Efficiency(高效):
 High module conversion efficiency (up to 16.8%) through innovative manufacturing technology (通过高水平生产工艺, 获得组件高转换效率)



Severe Weather Resilience (载荷能力):
 certified to withstand: wind load (2400 pascal) and snow load (500 pascal) 可承载2400帕风压和500帕积雪压强。



Durability against extreme environmental conditions (严酷环境的适应性): High salt mist and ammonia resistance certified by TUV SOUTH. (TUV南德测试认证通过高盐雾及高氨气腐蚀测试)

10年工艺质保 25年功率质保

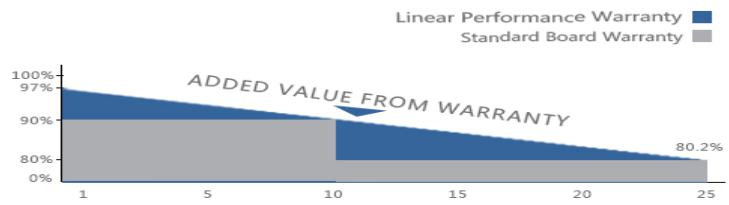

内部结构图

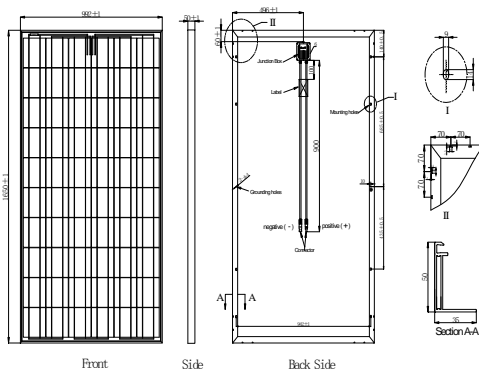

测试曲线图

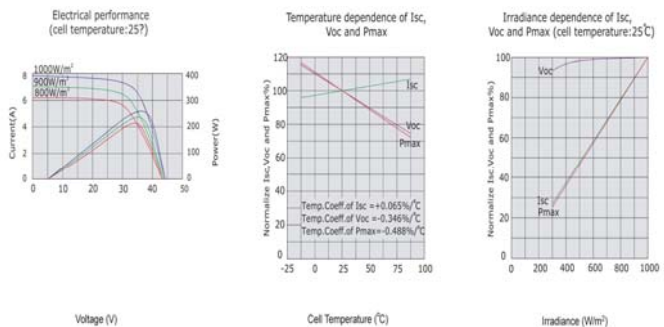

电性能参数

Model No. 型号	KPV250P-60	KPV255P-60	KPV260P-60	KPV265P-60	KPV270P-60	KPV275P-60
最大功率 (Pmax)	250W	255W	260W	265W	270W	275W
最佳工作电压 (Vmp)	30.5V	30.8V	31.1V	31.4V	31.7V	32V
最佳工作电流 (Imp)	8.20A	8.28A	8.37A	8.44A	8.52A	8.59V
开路电压 (Voc)	37.8V	38.0V	38.1V	38.6V	38.8V	39.36V
短路电流 (Isc)	8.85A	8.92A	8.98A	9.03A	9.09A	9.27A
组件尺寸	1640*992*40MM					
电池片排列	6*10PCS					
电池片尺寸	156*156MM					
重量	17.5KGS					