

**For a Free Quote:**

**Web: [EnergyPal.com/solar](http://EnergyPal.com/solar)**

**Call: 1-800-990-3725**

**Email: [contact@energypal.com](mailto:contact@energypal.com)**

# **EnergyPal**

## **Solar Panel Guide Specification Data Sheet**

**Lightway Solar Energy Technology Ltd**

**LW315-330-72P**

**LW330-72P**

Also available on the web at  
[EnergyPal.com/lightway-solar-energy-technology-ltd-solar-panels/lw330-72p](http://EnergyPal.com/lightway-solar-energy-technology-ltd-solar-panels/lw330-72p)



**Poly**

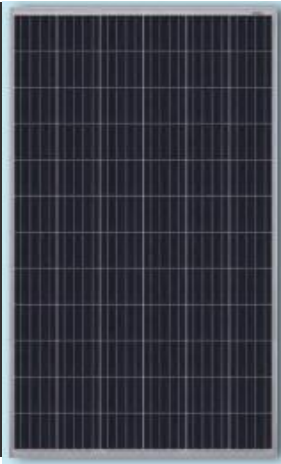

**LW315-330-72P**

LW330-72P LW325-72P

LW320-72P LW315-72P

**>18.7%**

Cell efficiency

World class poly efficiency  
Positive tolerance offer  
PID-free

**330W**

Highest power output

Tighter distribution and current sorting  
reduces power loss in system operation

**10 Year**

workmanship  
warranty

Certified for salt & ammonia corrosion,  
blowing sand and hail resistance  
conditions

**25 Year**

Linear power output  
warranty

Good temperature coefficient enables higher  
output in high temperature regions

Lightway, is a hi-tech corporation with its core business in R&D, manufacturing, and sale of high efficiency silicon based solar modules and system.

Lightway supply solar panel for to residential,commercial,utility etc projects all around the world.

Through strict selection of raw materials, stringent quality control and rigorous test in state of the art facilities . Lightway has always committed to higher efficiency, more stable and better cost performance products.



All information and data are subject to technical changes and test without notice. Lightway reserves the right of final interpretation.

[www.lightway-tech.com](http://www.lightway-tech.com)

## Electrical characteristics at Standard Test Conditions (STC)

Model	LW330-72P	LW325-72P	LW320-72P	LW315-72P
Max Power - P <sub>mpp</sub> (W)	330	325	320	315
Positive power tolerance	0 ~ +3	0 ~ +3	0 ~ +3	0 ~ +3
Open Circuit Voltage - Voc (V)	46.40	46.38	46.12	45.85
Short Circuit Current - Isc (A)	9.28	9.17	9.09	9.01
Max Power Voltage-V <sub>mpp</sub> (V)	37.65	37.39	37.28	37.09
Max Power Current - I <sub>mpp</sub> (A)	8.77	8.69	8.58	8.49
Module Efficiency	16.99	16.73	16.48	16.22

Electrical data relates to standard test conditions (STC) : irradiance 1000 W/m<sup>2</sup> ; AM 1.5 ; cell temperature 25°C measuring uncertainty of power is within ±3%. Certified in accordance with IEC61215, IEC61730-1/2

## Electrical Characteristics at Normal Operating Cell Temperature (NOCT)

Model	LW330-72P	LW325-72P	LW320-72P	LW315-72P
Max Power - P <sub>mpp</sub> (W)	239.58	235.95	232.32	228.69
Max Power Voltage - V <sub>mpp</sub> (V)	34.58	34.37	34.19	34.00
Max Power Current - I <sub>mpp</sub> (A)	6.93	6.87	6.80	6.73
Open Circuit Voltage - Voc (V)	42.41	42.24	42.04	41.84
Short Circuit Current - Isc (A)	7.25	7.20	7.14	7.08

Electrical data relates to normal operating cell temperature (NOCT): irradiance 800 W/m<sup>2</sup> ; wind speed 1 m/s ; cell temperature 45 °C; ambient temperature 20 °C measuring uncertainty of power is within ±3%

## Temperature Characteristics

Voltage Temperature Coefficient	-0.330%/K
Current Temperature Coefficient	+0.058%/K
Power Temperature Coefficient	-0.410%/K

## Mechanical Characteristics

## Maximum Ratings

Maximum system voltage	1000
Series fuse rating (A)	15
Reverse current overloa	25

## Mechanical Characteristics

Dimensions	1960*991*40mm
Weight	23kg
Frame	Anodized aluminum profile
Front glass	White toughened safety glass, 3.2 mm
Cell Encapsulation	EVA (Ethylene-Vinyl-Acetate)
Back Sheet	Composite film
Cells	6 x 12 pieces poly solar cells series strings (156.75 mm x 156.75 mm)
Junction Box	Rated current ≥ 12A, IP ≥ 67, TUV
Cable	Length 900 mm, 1 x 4 mm <sup>2</sup>
Connector	MC 4/ compatible with MC 4

## Packaging

Container 20'	270pcs	Temp. range	-40°C to + 85°C
Container 40'	570pcs	Hail	max.diameter of 25mm with 23m/s impact speed
Container 40'HC	621pcs	Max. capacity	Snow 5400 Pa, wind 2400 Pa

## System Design

Application class	A
Safety class	II

## Dimensions

Note: Module layout below only valid for modules with 35mm thickness. All dimensions in mm.

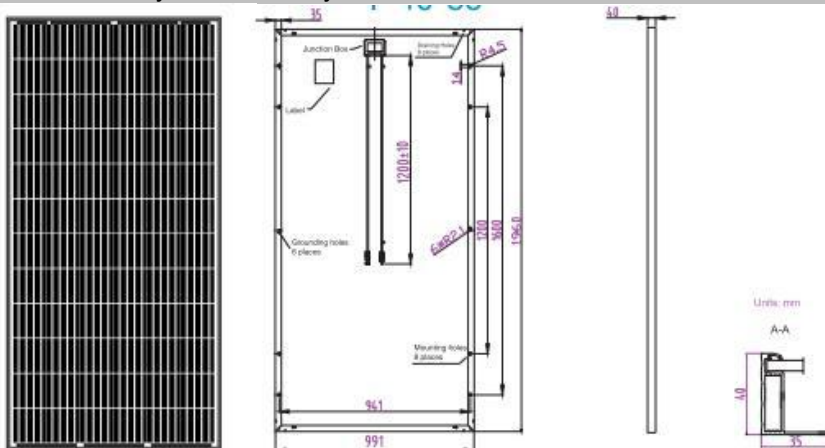

## IV-Curves

