

For a Free Quote:

Web: EnergyPal.com/solar

Call: 1-800-990-3725

Email: contact@energypal.com

EnergyPal

Solar Panel Guide Specification Data Sheet

Asia Rodmo Solar Technological Co., Ltd.

NPV-M-70-90M

NPV-M-70

Also available on the web at
EnergyPal.com/asia-rodmo-solar-technological-co-ltd-solar-panels/npv-m-70



RP 20W-NPV-M-20A



ELECTRICAL PARAMETER

Model	NPV-M-70	NPV-M-80	NPV-M-90
Maximum Power(Pm)	70W	80W	90W
Open Circuit Voltage(Voc)	21.80	22.10	22.50
Maximum Power Voltage (Vpm)	17.30	17.30	17.30
Short Circuit Current(Isc)	4.55	5.10	5.75
Maximum Power Current (Ipm)	4.05	4.62	5.20
Operating Temperature	-40°F to 185°F/-40°C to +85°C		
Maximum System Voltage	1000 V DC		
Insulation	Above 100MΩ		

MECHANICAL CHARACTERISTICS

Cell	monocrystalline Silicon 125mmX125mm
No. of cells and connections	36 (4X9)
Dimension (mm)	1196X534X35
Weight	8 KG
Type of output	Junction Box

TEST AND COEFFICIENT

Cable	LAPP (4.0MM)
Temperature coefficient of Isc	+0.10%/°c
Temperature coefficient of Voc	-0.37%/°c
Temperature coefficient of Power	-0.45%/°c
NOTC	48±2°c

DIMENSIONS

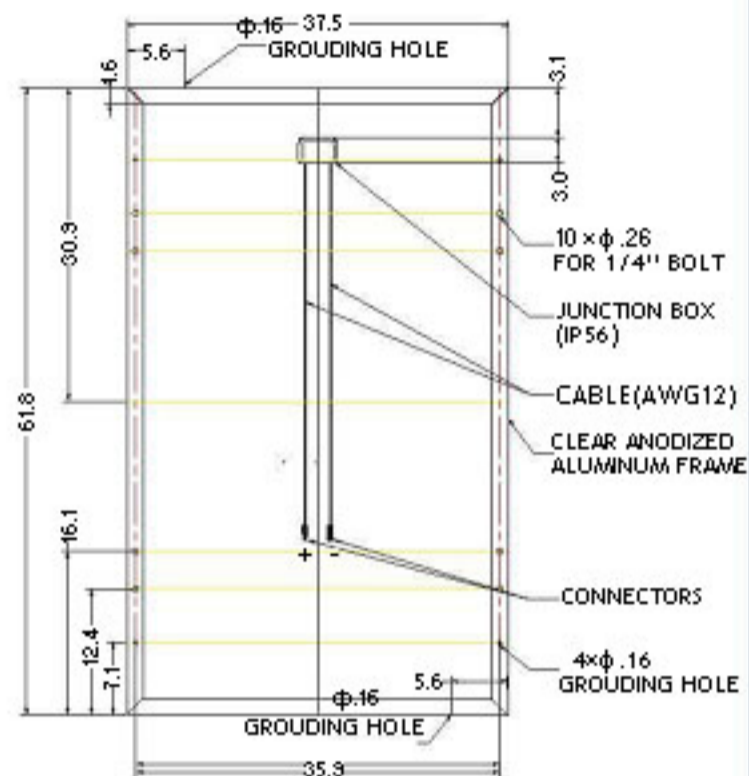

STC

Irradiance 1000W/M², AM=1.5, Temperature 25°C

NOTC

Nominal Operation Cell Temperature

Quality Guarantee

Nominal keep more than 90% power in 20 year, 80% in 25 years

IV CURVES

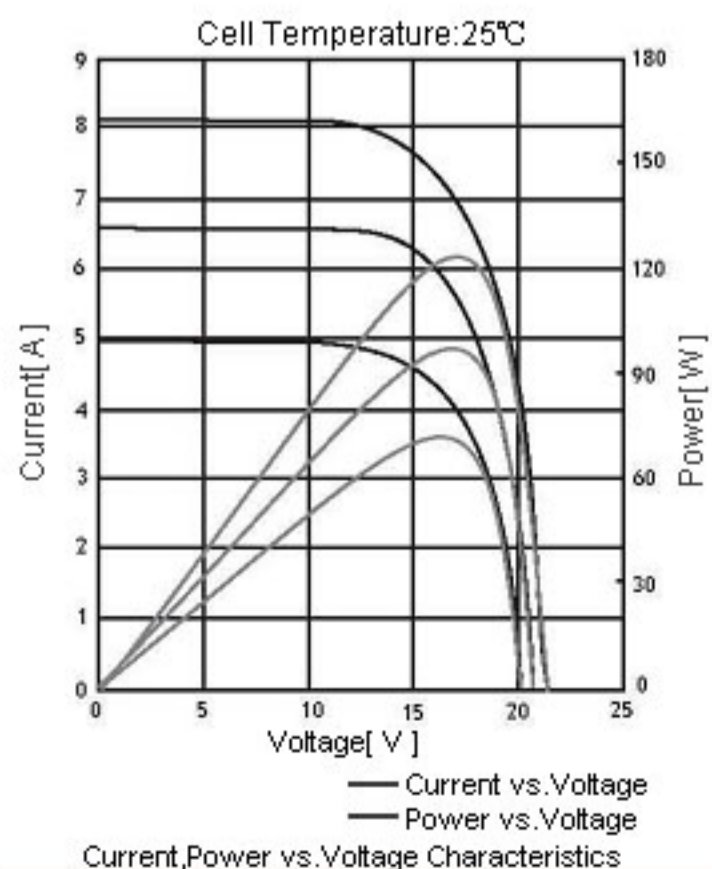

The publication summarises product warranty and specification are subject to change without notice

China Rodmo Technological Com.,Ltd.

www.rodmo.com • jerry@rodmo.com

© China Rodmo 2007