

For a Free Quote:

Web: EnergyPal.com/solar

Call: 1-800-990-3725

Email: contact@energypal.com

EnergyPal

Solar Panel Guide Specification Data Sheet

Resun Solar Energy Co., Ltd.

RS6C-M

RS6C 280M

Also available on the web at
EnergyPal.com/resun-solar-energy-co-ltd-solar-panels/rs6c-280m

RS6C-M

250/255/260/265/270/275/280M



Resun Solar Energy Co.,Ltd

All-Purpose Module

RS6C is a robust solar module with 60 solar cells. These modules can be used for on-grid solar applications. Our meticulous design and production techniques ensure a high-yield, long-term performance for every module produced. Our rigorous quality control and in-house testing facilities guarantee Resun Solar's modules meet the highest quality standards possible.

Monocrystalline Silicon Solar Modules

Features



High module conversion efficiency (up to 17.10%), through superior manufacturing technology



Guaranteed 0-+5W positive power output tolerance ensures high reliability



Anti-reflective, hydrophobic coating improves light absorption and reduces surface dust



Excellent performance under low light environments (mornings, evenings and cloudy days)



Entire module certified to withstand high wind loads (2400 Pascal) and snow loads (5400 Pascal)*

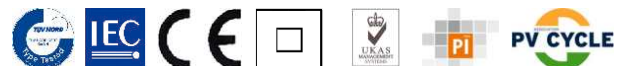
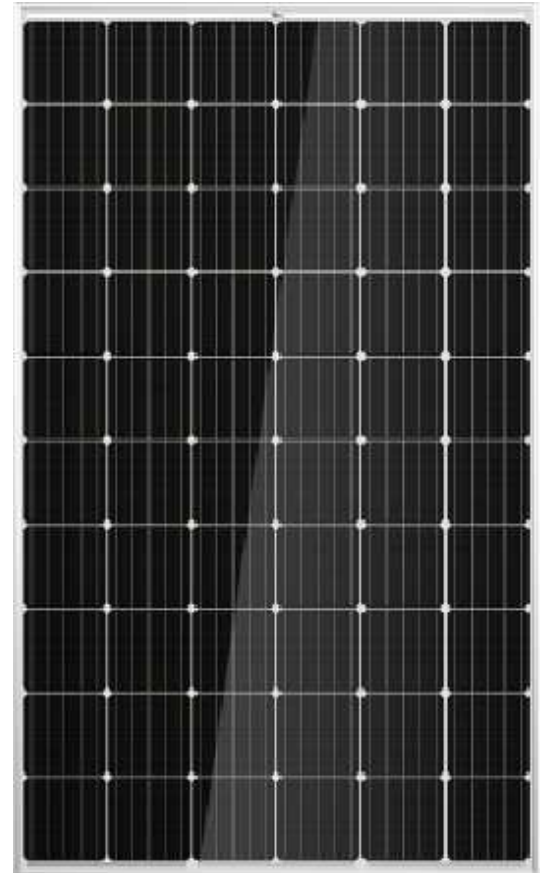

All-purpose Module

Sales network covers more than 50 countries, providing customers with instant after sales service and an efficient supply-chain, our clients can be found throughout the world, such as North America, Europe, Oceania, Eastern Europe, East Asia, Middle Easter and Africa etc. Resun Solar team works closely with our customers to provide them with solutions for all solar needs.



Resun reputation is founded on more than 300MW of high performance solar modules installed around the world.

Industry-leading warranty

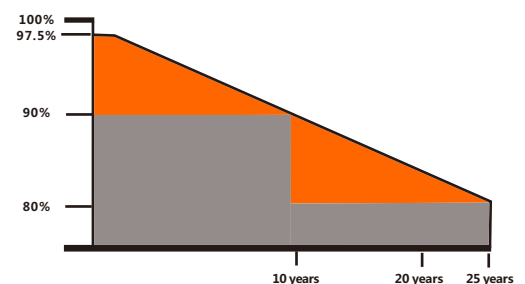

- 25 year transferable power output warranty: 10year/90%;25year/80%.
- Based on nominal power.
- 10 year material and workmanship warranty.

RS6C-M

250/255/260/265/270/275/280M

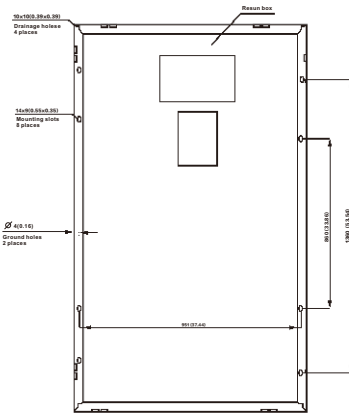
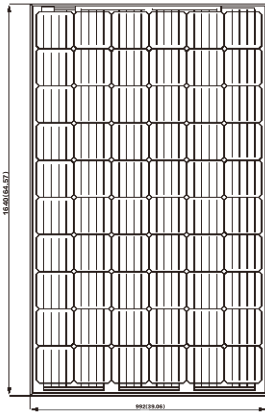

Electrical Data

STC	RS6C 250M	RS6C 255M	RS6C 260M	RS6C 265M	RS6C 270M	RS6C 275M	RS6C 280M
Nominal Maximum	250W	255W	260W	265W	270W	275W	280W
Optimum Operating	30.5V	30.7V	30.9V	31.1V	31.2V	31.3V	31.7V
Optimum Operating	8.20A	8.31A	8.41A	8.52A	8.65A	8.79A	8.84A
Open Circuit voltage(Voc)	36.6A	36.8A	37.1A	37.3A	37.4A	37.6A	38.4A
Short Circuit Current(Isc)	9.01A	9.14A	9.25A	9.37A	9.52A	9.66A	9.42A
Module Efficiency	15.37%	15.67%	15.98%	16.29%	16.60%	16.90%	17.10%
Operating Temperature	-40°C ~ +85°C						
Maximum System Voltage	1000V(IEC)/600V(UL)						
Maximum Series Fuse Rating	15A						
Application Classification	Class A						
Power Tolerance	0 ~ +5W						

Under Standard Test Conditions (STC) of irradiance of 1000W/m², spectrum AM 1.5 and cell temperature of 25°C

NOCT	RS6C 250M	RS6C 255M	RS6C 260M	RS6C 265M	RS6C 270M	RS6C 275M	RS6C 280M
Nominal Maximum Power(Pmax)	185W	188W	192W	195W	198W	202W	209W
Optimum Operating Voltage(Vmp)	27.9V	28.1V	28.4V	28.6V	28.8V	29.1V	29.4V
Optimum Operating Current(Imp)	6.63A	6.68A	6.76A	6.82A	6.88A	6.94A	7.01A
Open Circuit voltage(Voc)	34.9A	35.0A	35.1A	35.2A	35.3A	35.4A	35.7A
Short Circuit Current(Isc)	7.05A	7.12A	7.19A	7.28A	7.36A	7.50A	7.61A

Under Normal Operating Cell Temperature . irradiance of 800 W/m², spectrum AM 1.5, ambient temperature 20°C wind speed 1m/s

Mechanical Data

Cell Type	Mono-crystalline 156 x 156mm, 4 or 5 Bus bars
Cell Arrangement	60 (6x10)
Dimensions	1640x992x40mm (64.57x39.06x1.57in)
Weight	19kg
Front Cover	3.2mm Tempered Glass
Frame Material	Anodized Aluminum Alloy
J-BOX	IP65 or IP67, 6 Diodes
Cable	4mm2(IEC)/12AWG(UL), 1150mm
Connectors	Mc4 or MC4 Comparable
Standard Packaging (Modules per Pallet)	32pcs
Module Pieces per container(40HQ)	832pcs(40'HQ)

IV-Curves

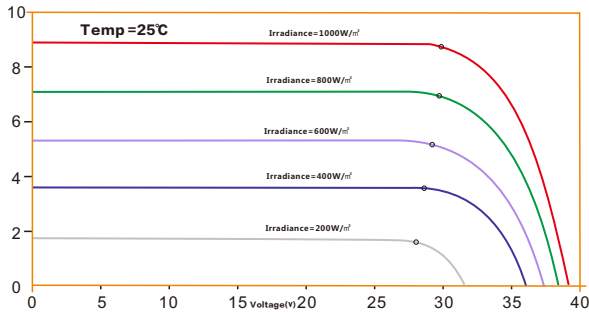

Temperature Characteristics

Nominal Operating Cell Temperature(NOCT)	45±2°C
Temperature Coefficient of Pmax	-0.43%/°C
Temperature Coefficient of Voc	-0.34%/°C
Temperature Coefficient of Isc	0.065%/°C

Packing Configuration

Container	20' GP	40' HQ
Pieces	300	832

Resun Solar Energy Co.,Ltd

Add:No 15 Puzhuang Avenue,Wuzhong District,Suzhou, Jiangsu China.

Tel:+86 0512 66292101

Fax:+86 0512 66293858

E-mail:info@resunsolar.com

http://www.resunsolar.com