

For a Free Quote:

Web: EnergyPal.com/solar

Call: 1-800-990-3725

Email: contact@energypal.com

EnergyPal

Solar Panel Guide Specification Data Sheet

Silicon Leaf Solar

S6-60

S6-60-235

Also available on the web at
EnergyPal.com/silicon-leaf-solar-solar-panels/s6-60-235



PV Module S6-60



High Efficiency PV Modules

Strengths

- Positive power tolerance
- High Efficiency Mono Crystalline Modules
- TUV Certifications:
 - EN IEC 61215 : 2005
 - EN IEC 61730-1 : 2004 / 2007
 - EN IEC 61730-2 : 2004 / 2007
- Qualified for Extended Mechanical Load test up to 5400 Pascal : EN IEC 61215
- Withstands heavy loading due to snow & ice; Has higher safety margin for storm weather and gale winds
- UL Certification: ANSI / UL 1703 (USA & Canada)
- California Energy Commission Listed

Product Guarantee : 5 years

Limited Power Warranty : 90% @ 12 Years
80% @ 25 Years

Typical Electrical Characteristics

| | | S6-60 | | | | | | |
|---------------------------------------|---------|-------------------------------------|-------|-------|-------|-------|-------|--|
| Type | | 225 | 230 | 235 | 240 | 245 | 250* | |
| Max Power | Pmp (W) | 225 | 230 | 235 | 240 | 245 | 250* | |
| Power Tolerance | (W) | +0 to 4.9 Wp or ± 2.5% | | | | | | |
| Max Power Voltage | Vmp(V) | 28.63 | 29.24 | 29.48 | 29.60 | 29.80 | 30.01 | |
| Max Power Current | Imp (A) | 7.93 | 7.87 | 8.00 | 8.12 | 8.25 | 8.33 | |
| Open Circuit Voltage | Voc (V) | 37.50 | 37.44 | 37.44 | 37.50 | 37.50 | 37.54 | |
| Short Circuit Current | Isc (A) | 8.52 | 8.49 | 8.52 | 8.58 | 8.73 | 8.76 | |
| Electrical parameters tolerance | | ±5% | | | | | | |
| Max System Voltage (Europe / USA) | VDC | 1000/600 | | | | | | |
| Number, type and arrangement of cells | | 60, Mono-Crystalline, 10 x 6 Matrix | | | | | | |
| Cell Size | | 6" x 6" / 156 x 156 mm | | | | | | |
| No. of By-pass Diodes | | 3 | | | | | | |
| Max Series Fuse | (A) | 15 | | | | | | |
| Pm Temperature Co-efficient (γ) | (%/°C) | -0.45 | | | | | | |
| Isc Temperature Co-efficient (α) | (%/°C) | +0.035 | | | | | | |
| Voc Temperature Co-efficient (β) | (%/°C) | -0.365 | | | | | | |
| NOCT at STC | (°C) | 45±1 | | | | | | |

Mechanical Characteristics

| | | |
|-----------------------------|----|----------------------------------|
| Junction Box | | Tyco |
| Type of connector | | Tyco |
| Dimensions (L x W x Th) | mm | 1657 x 987 x 42 |
| Weight | Kg | 19.0 |
| No. of Drain Holes in Frame | | 12 |
| Glass Type and Thickness | | 3.2 mm Thick, Low iron, Tempered |

Packing Configuration

| | |
|-----------------------|---------------------------|
| Packing Configuration | 24 Modules in each pallet |
| 1 * 20 Ft | 144 Modules |
| 1 * 40 Ft STD | 336 Modules |
| 1 * 40 Ft HQ | 672 Modules |

Absolute Ratings

| | | |
|-----------------------|------|-----------|
| Operating Temperature | (°C) | -40 ~ +85 |
| Storage Temperature | (°C) | -40 ~ +85 |

NOTE: The data presented may change due to further improvements in the product.
* Approved for IEC standards only.

PV Module S6-60

Typical I-V Curves

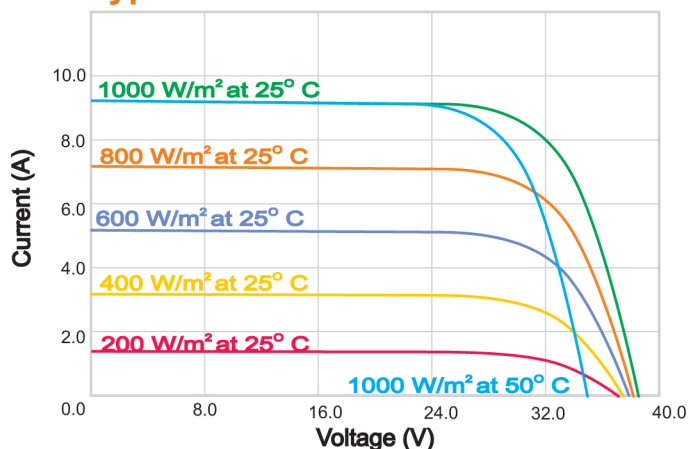

Current/voltage dependence on irradiance and module temperature. These I-V curves indicate the effect of temperature and light intensity on module Performance.

Dimensions

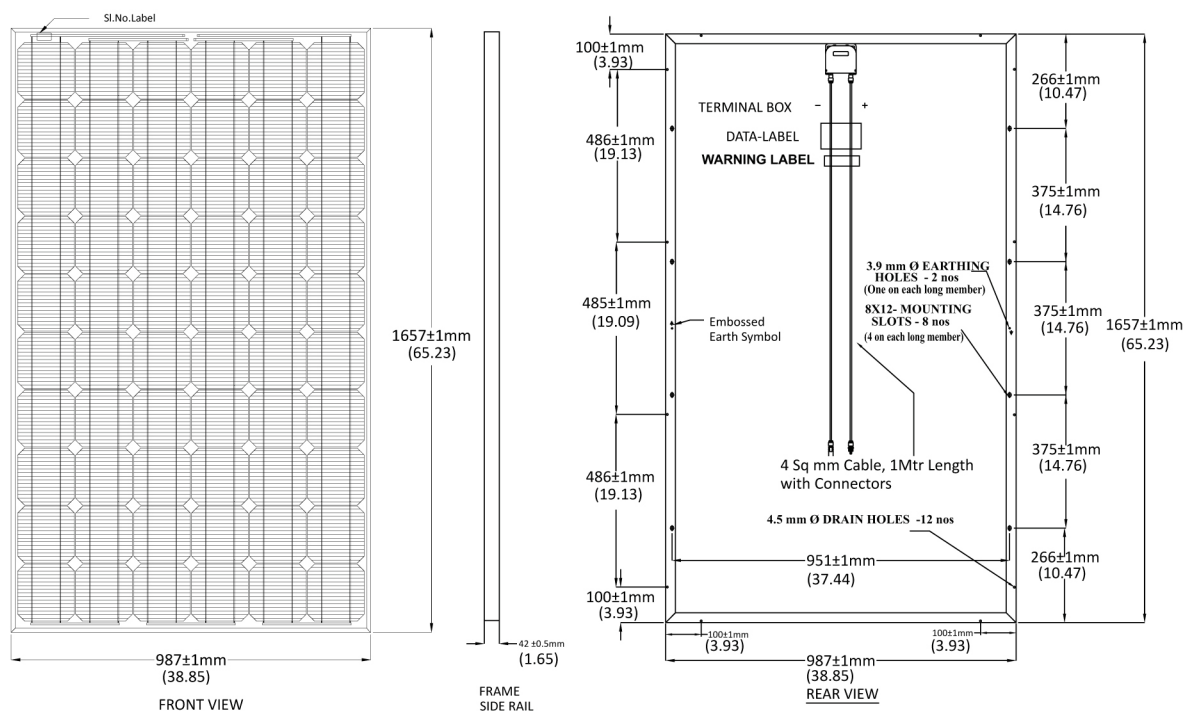

Dimensions given in Parentheses are in inches

PV Module Products

- M6-72 Family Series (305Wp to 125Wp) : M6-72, M6-60, M6-54 & M6-36 - Certified for IEC Standards
M6-60: Certified for UL (USA & Canada) Standard; M6-72: Certification for UL (USA & Canada) is in Progress
- S6-60 Family Series (250Wp to 120Wp) : S6-60, S6-54 & S6-36 - Certified for IEC Standards
S6-60 - Certified for UL (USA & Canada) Standard
- S6-72 Family Series (300Wp to 285Wp) : Certification for IEC & UL (USA & Canada) Standards
- S5-96 Family Series (250Wp to 75Wp) : S5-96, S5-72, S5-60, S5-54 & S5-36 - Certified for IEC Standards



SILICON LEAF

Renewable Energy - An ISO 9001 : 2015 Certified Company