

For a Free Quote:

Web: EnergyPal.com/solar

Call: 1-800-990-3725

Email: contact@energypal.com

EnergyPal

Solar Panel Guide Specification Data Sheet

Wuxi Sunket New Energy Technology Co., Ltd.

SKT40-45M6-12

SKT40M6-12

Also available on the web at

EnergyPal.com/wuxi-sunket-new-energy-technology-co-ltd-solar-panels/skt40m6-12

10~75 Watt

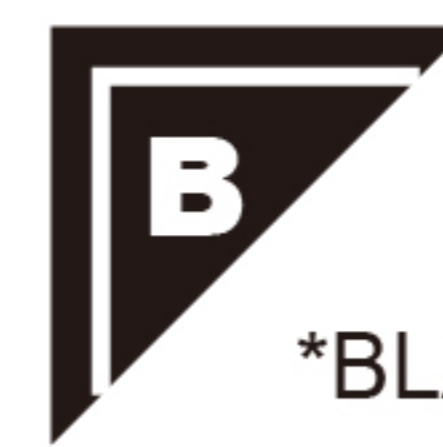

*BLACK FRAME/BLACK BACK-SHEET PRODUCTS ARE AVAILABLE UPON REQUEST

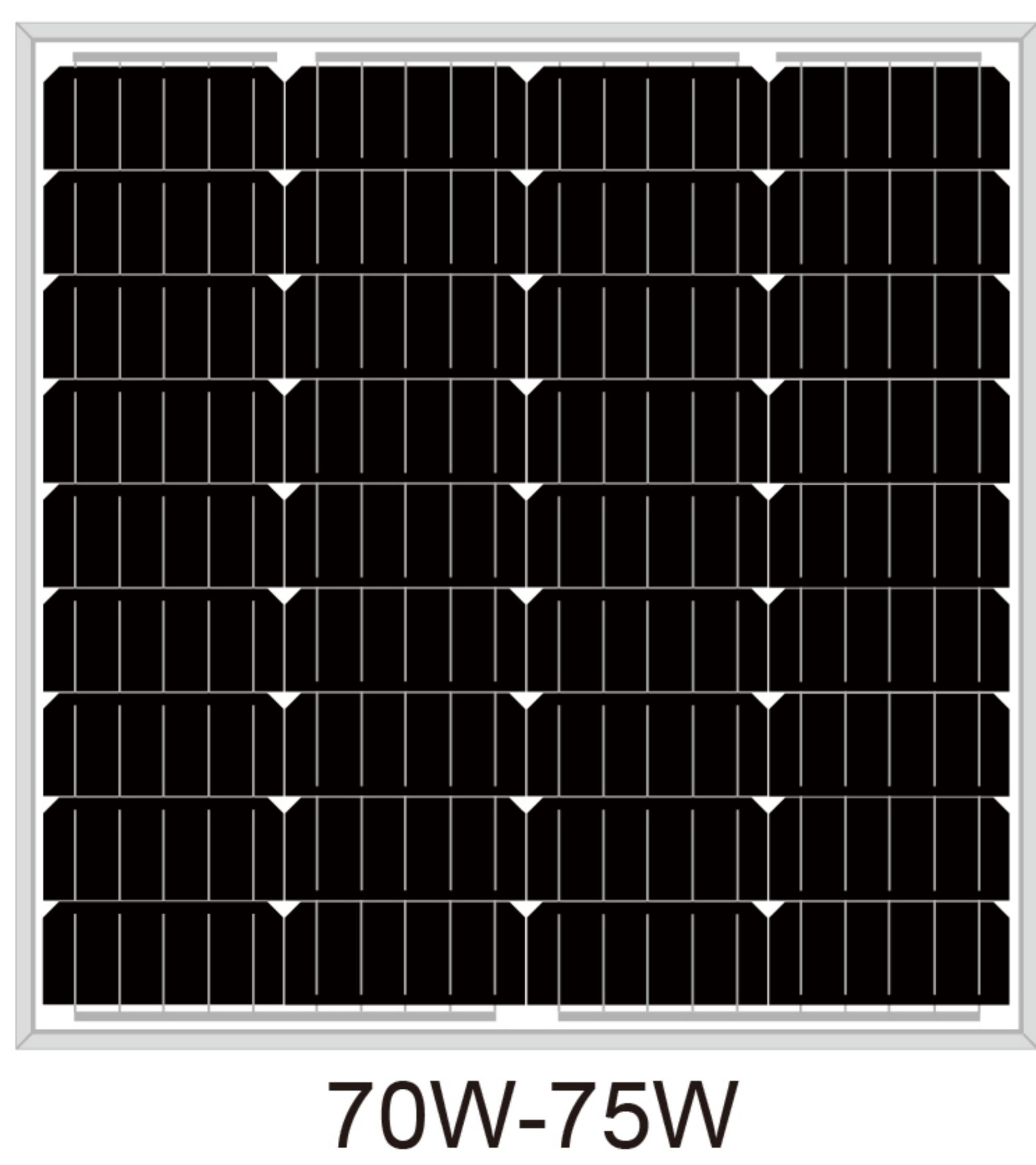

70W-75W

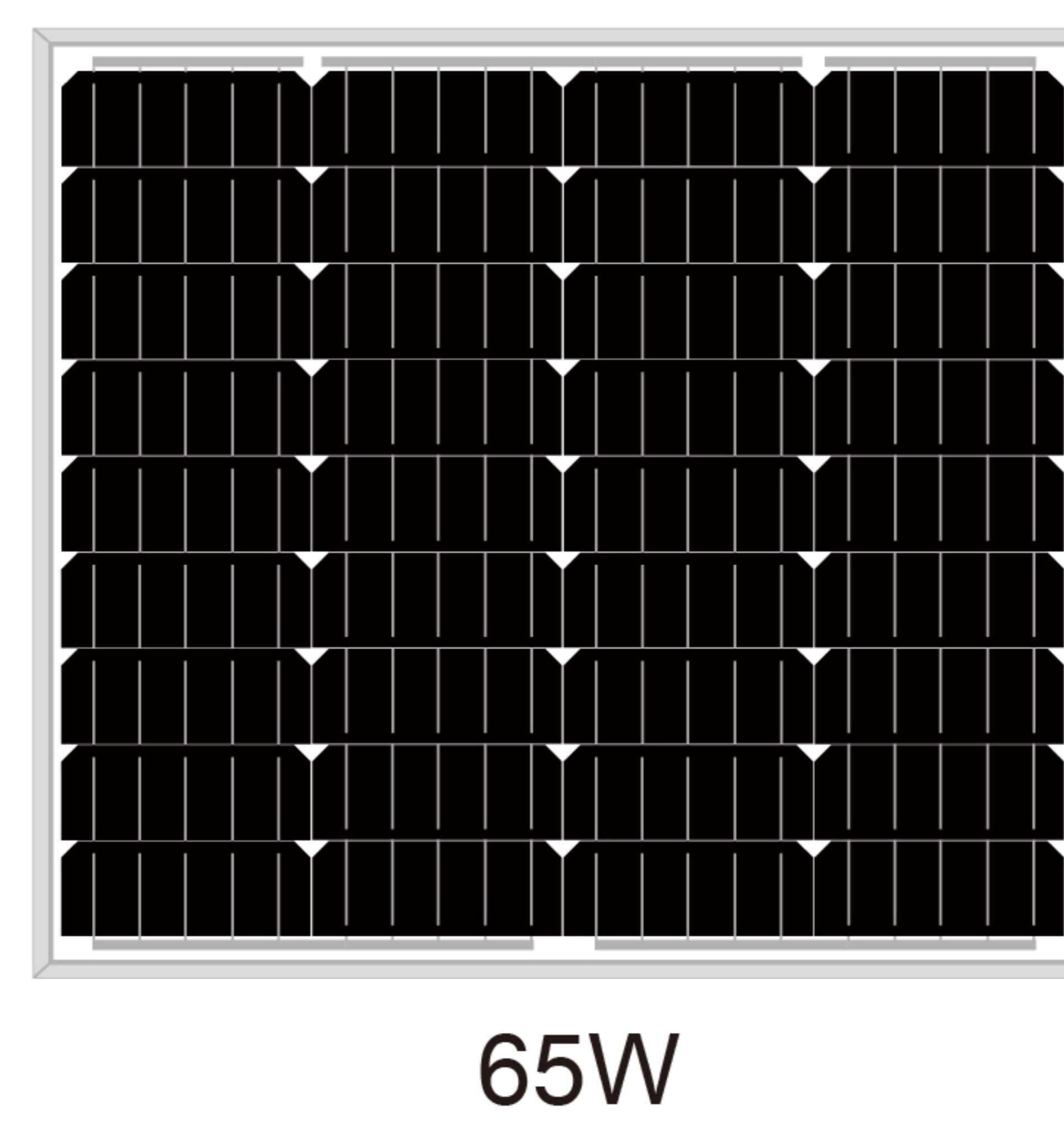
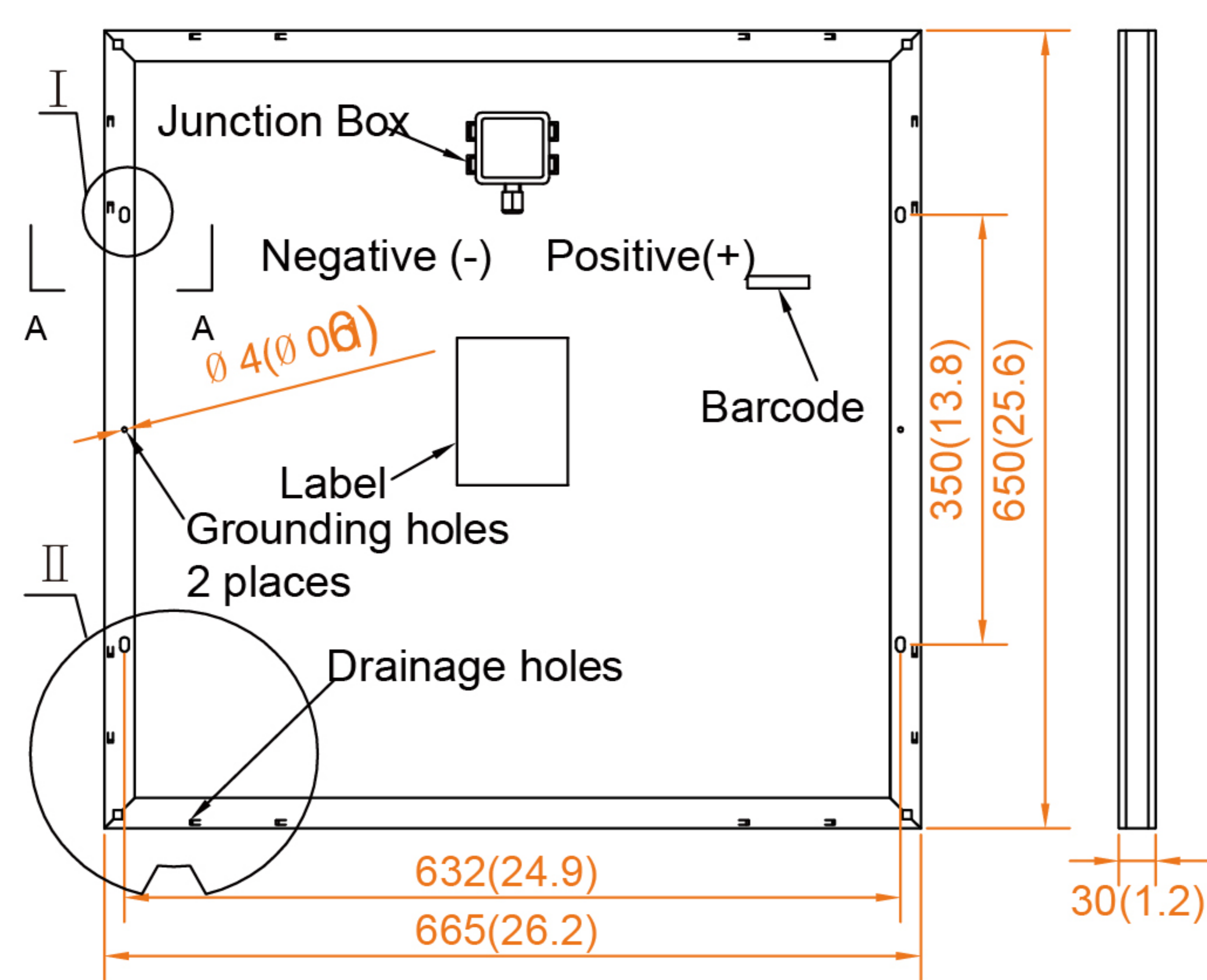

65W

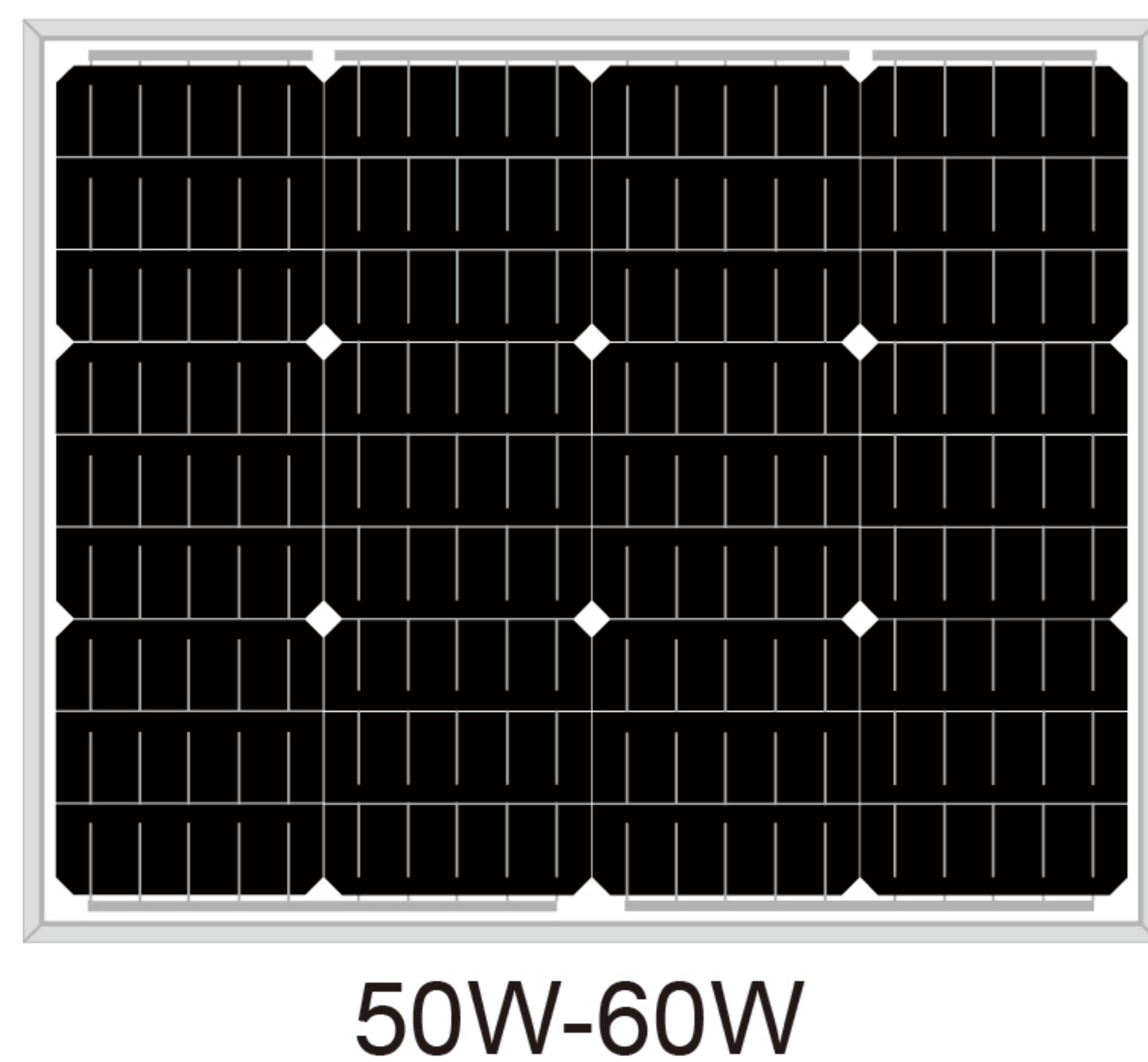
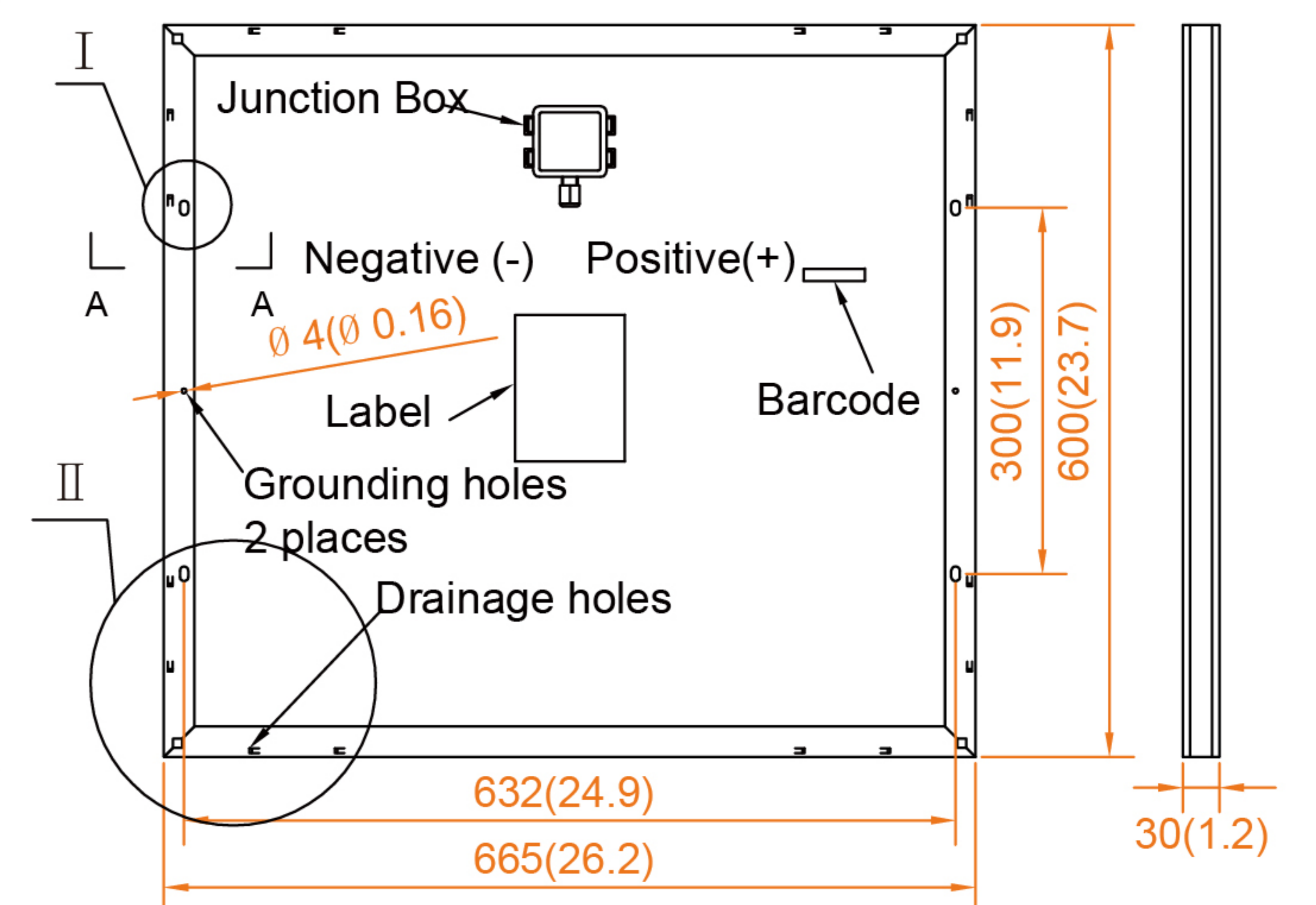

50W-60W

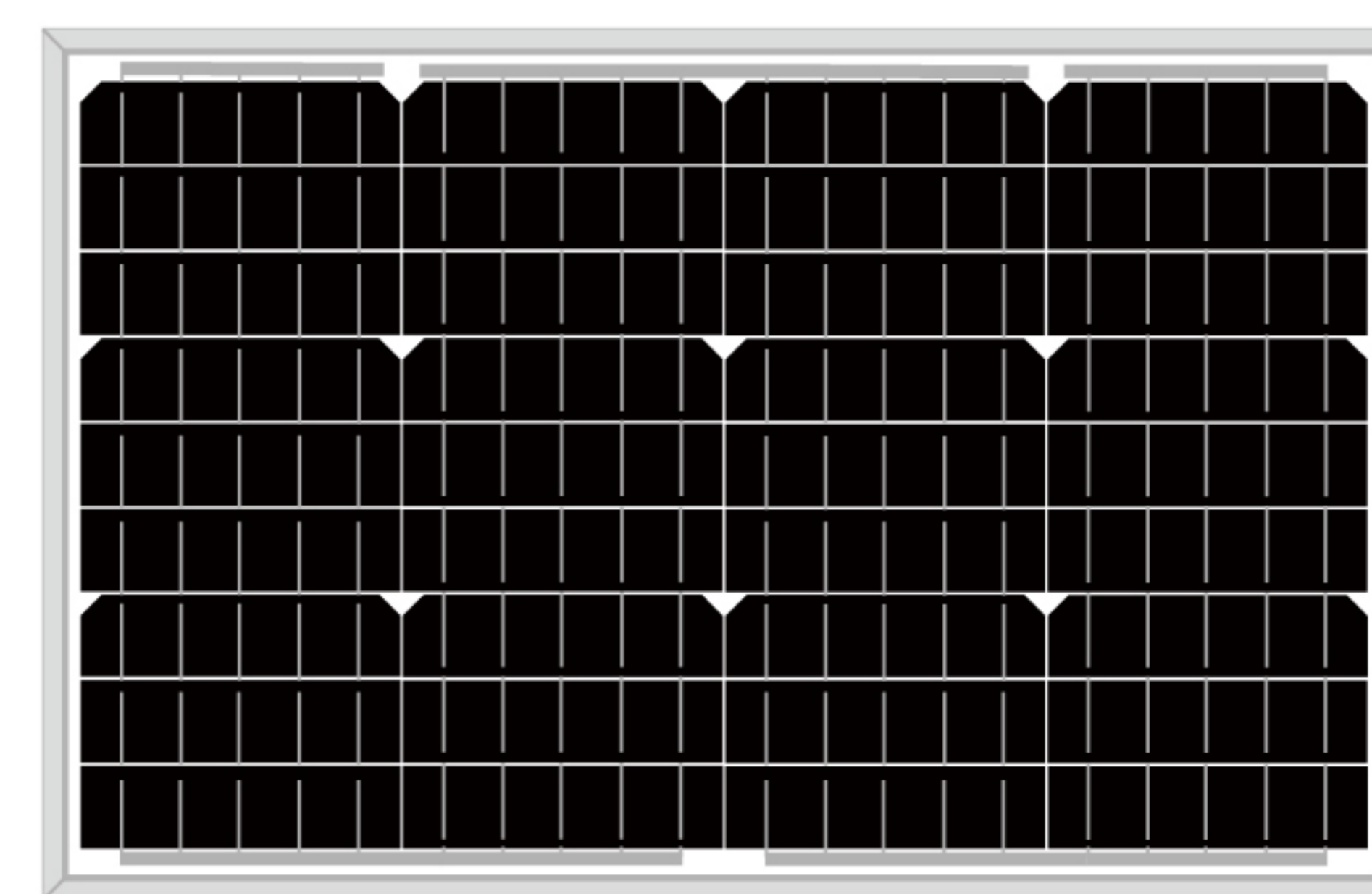
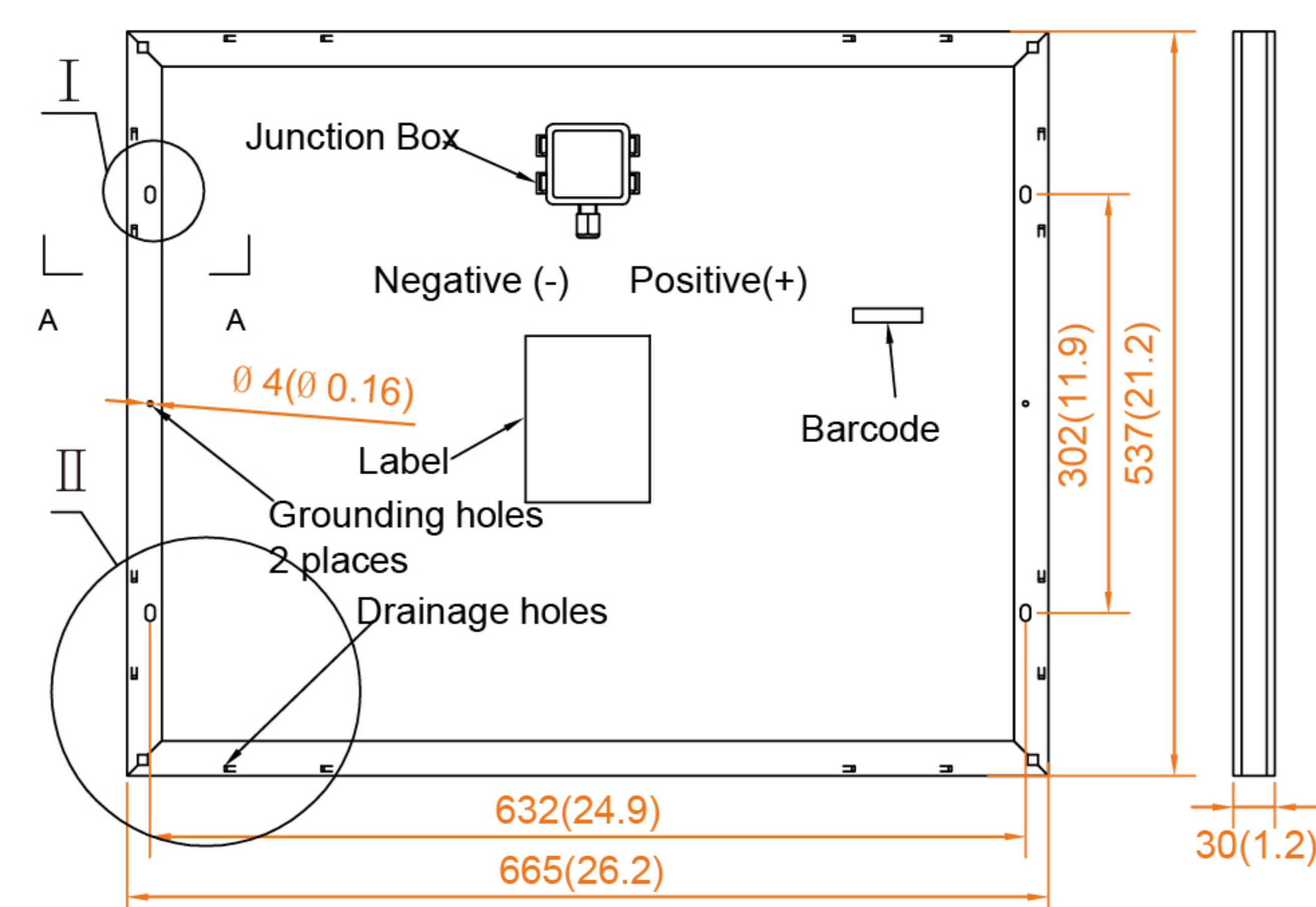

40W-45W

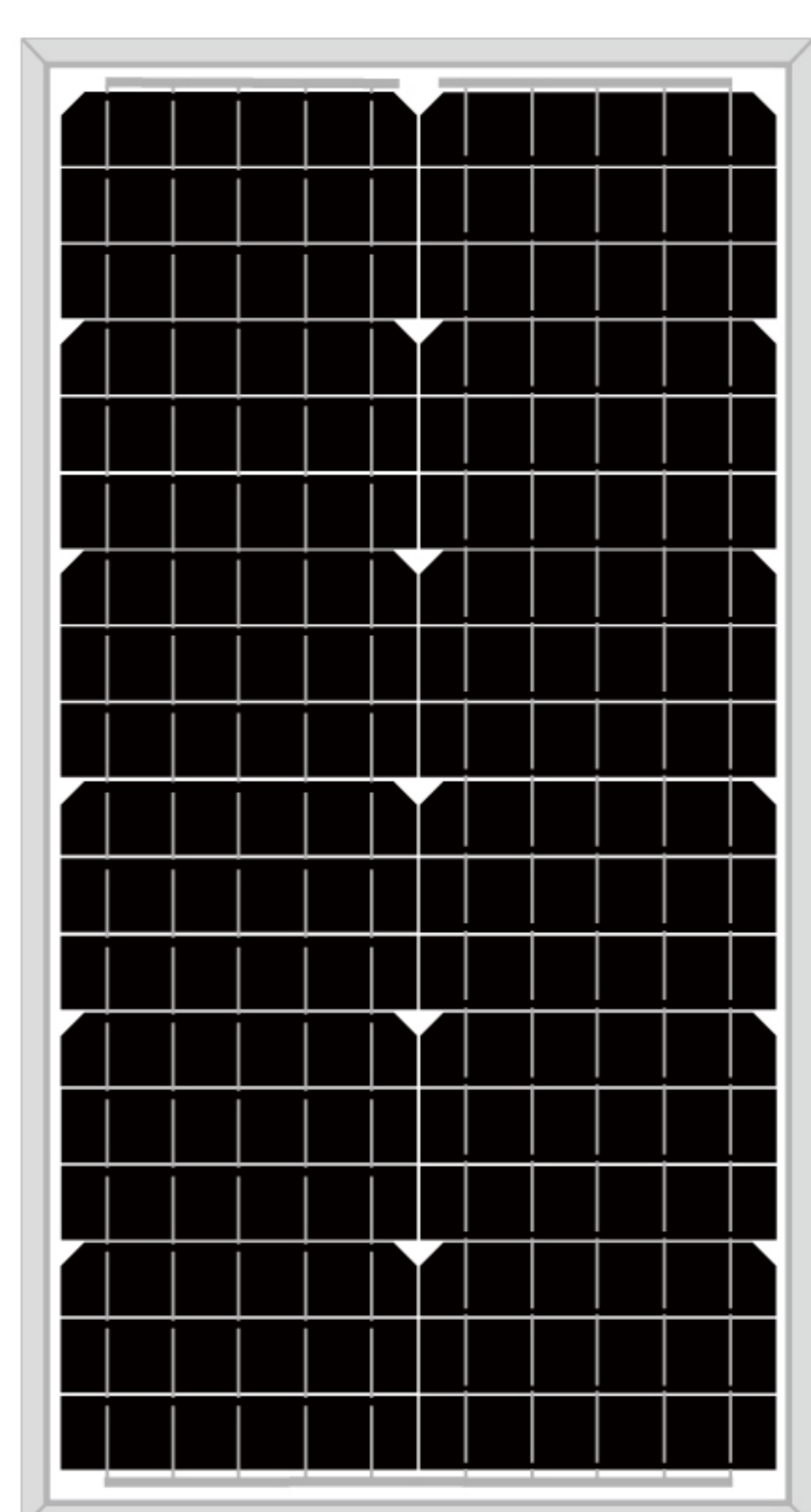
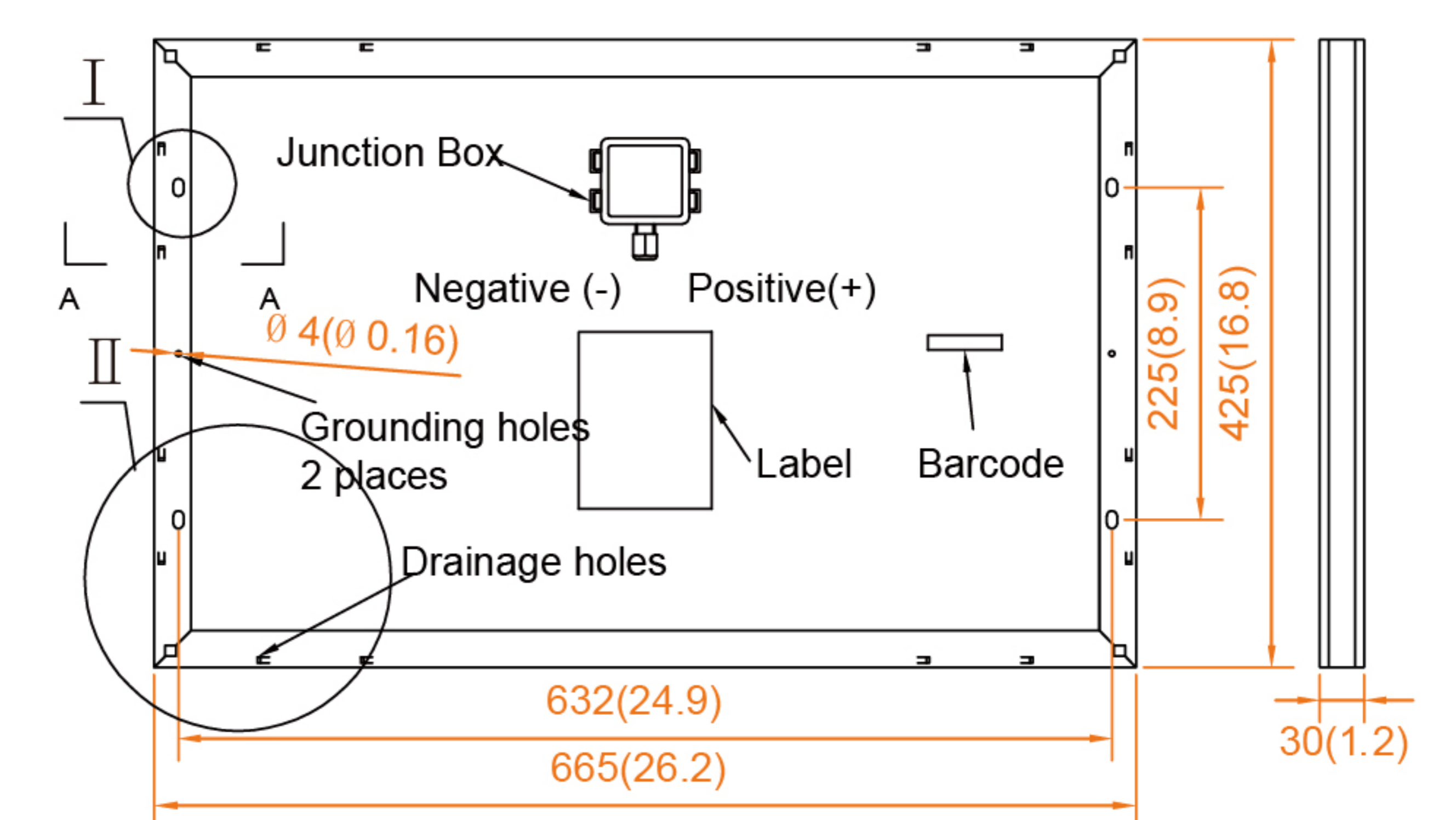

30W-35W

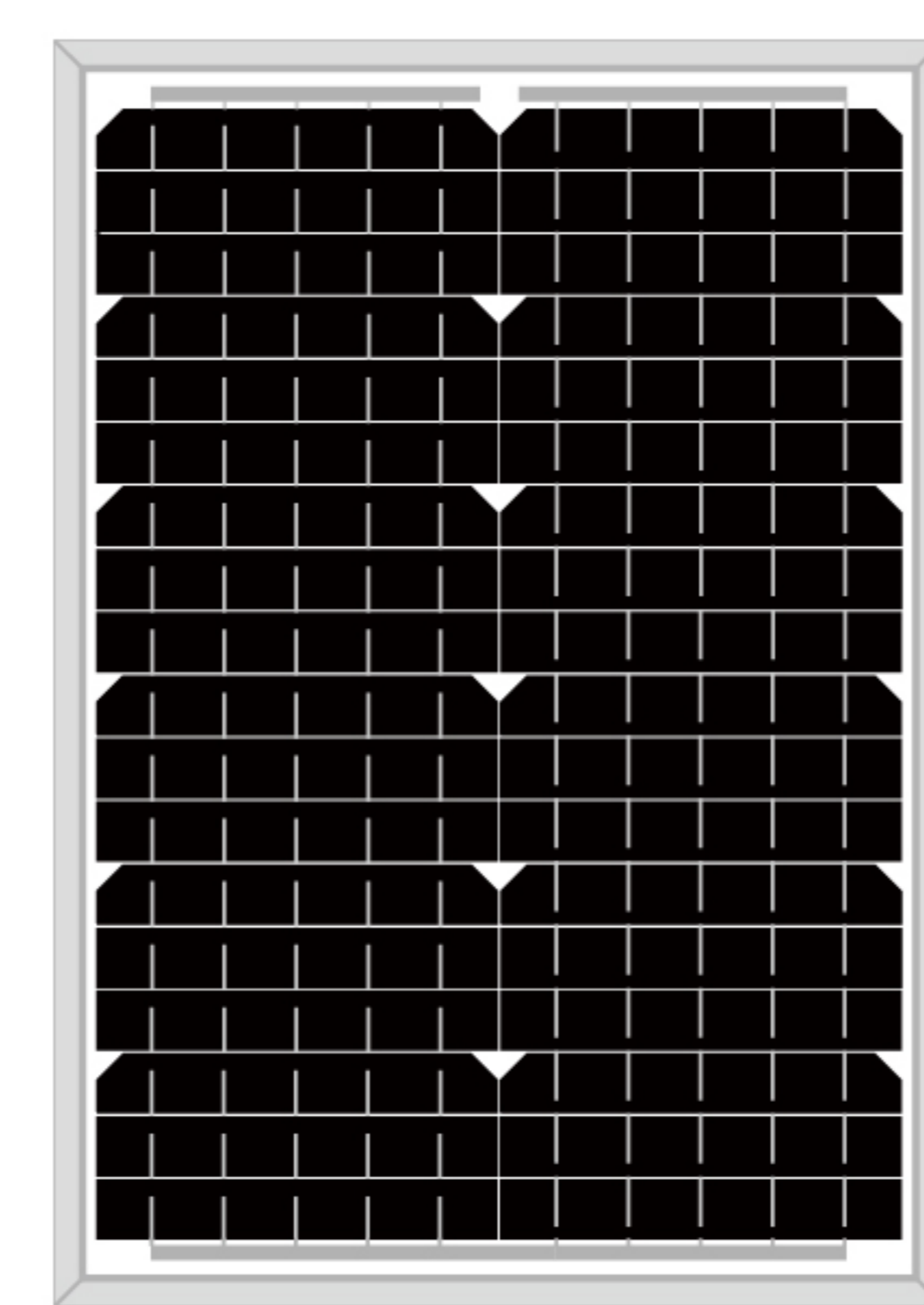
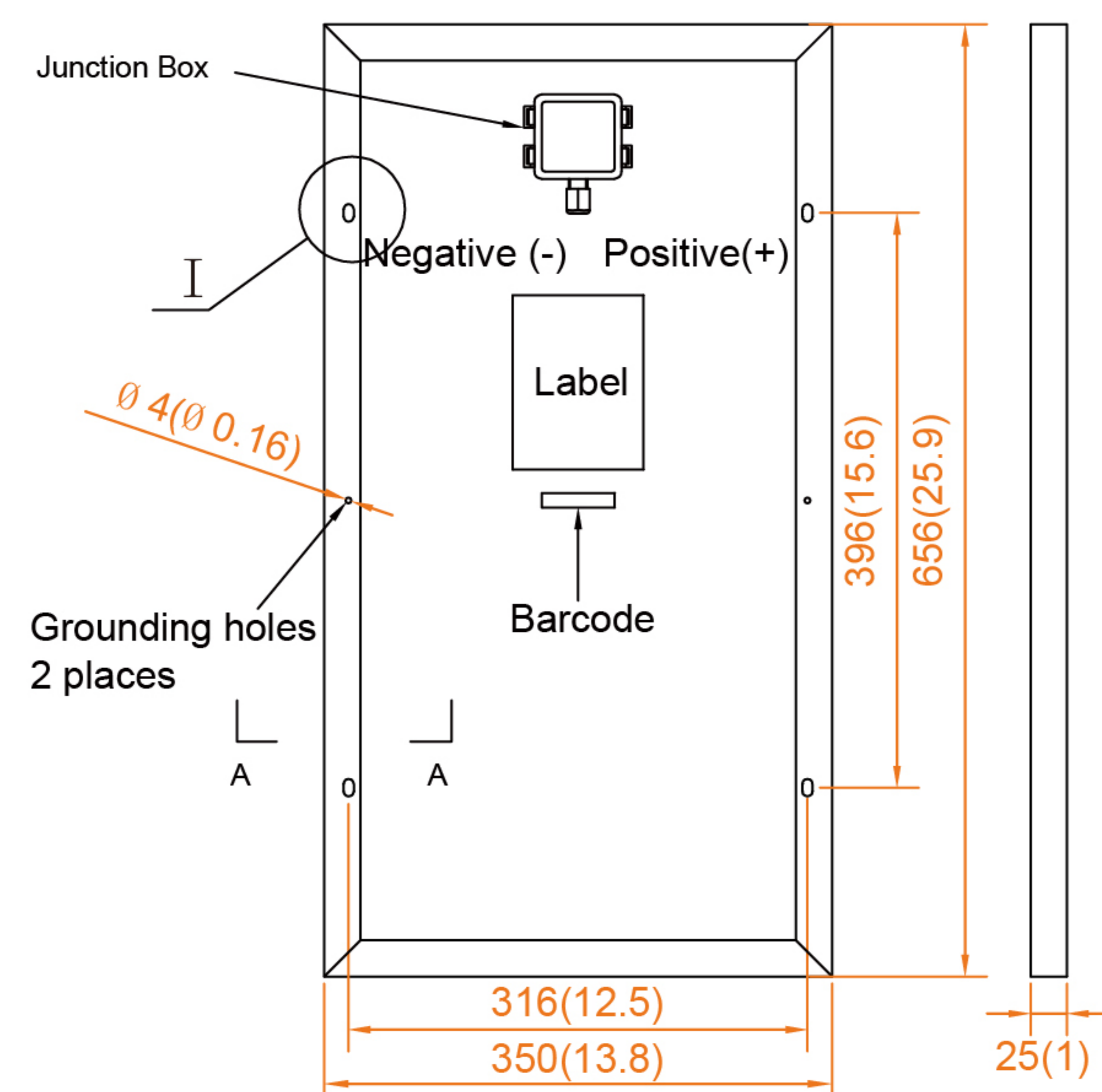

20W-25W

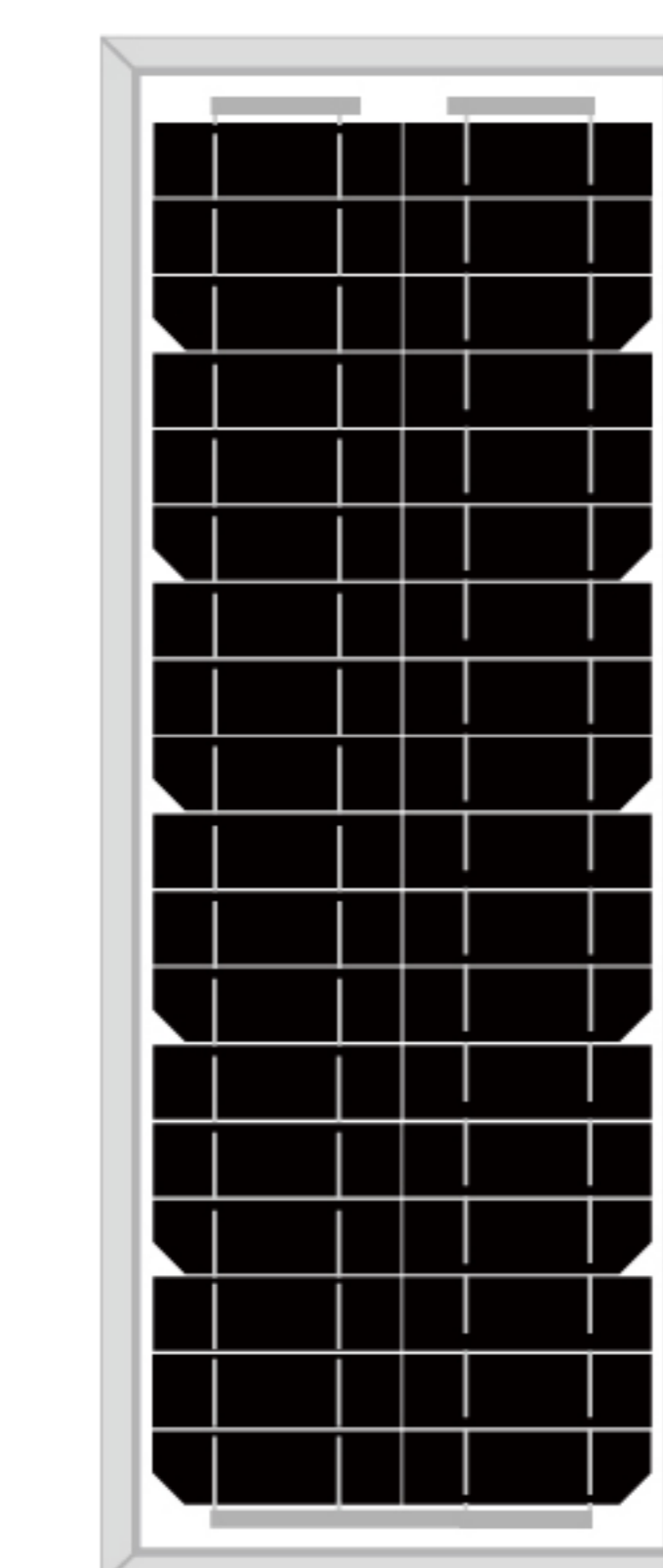
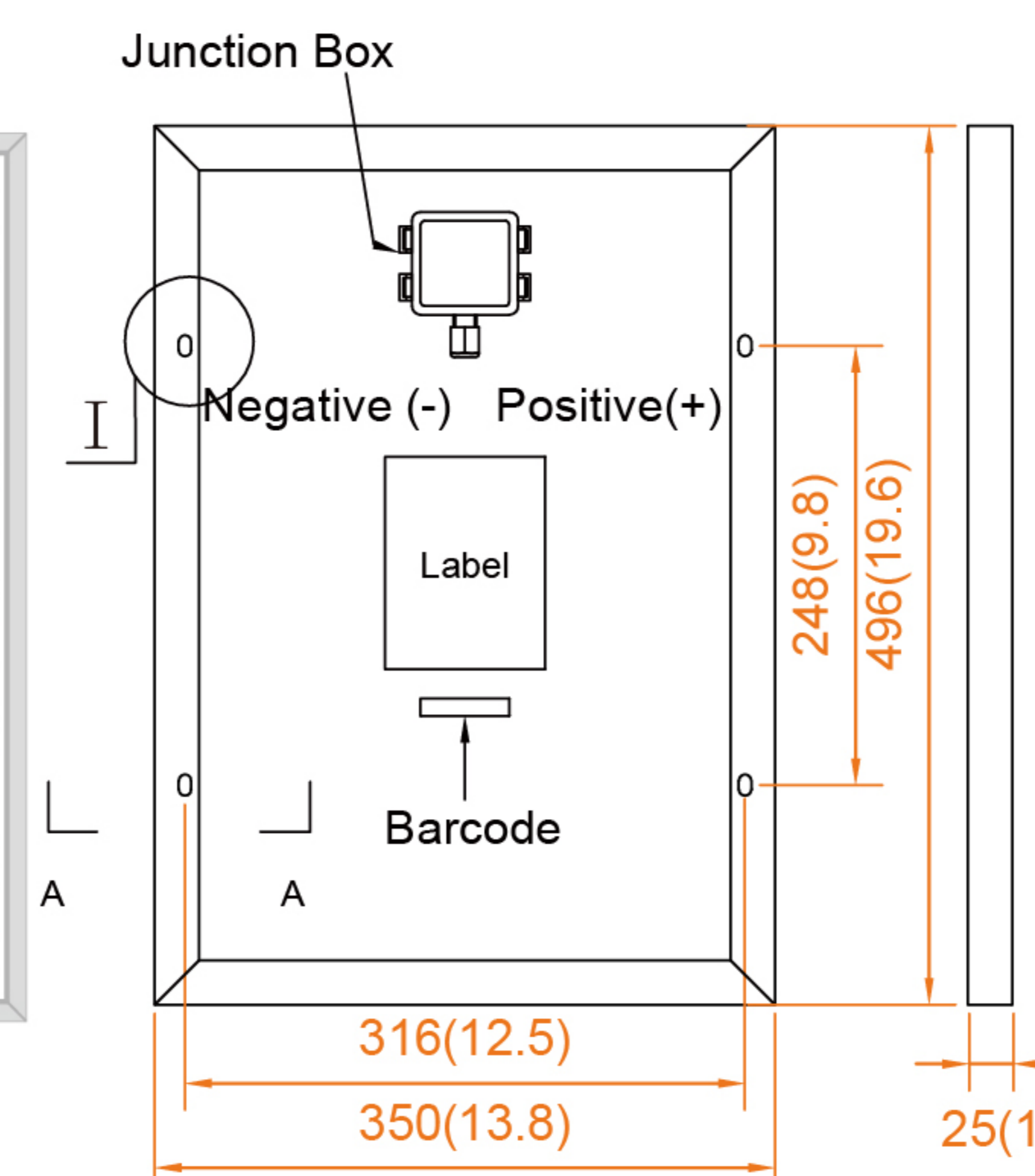

10W

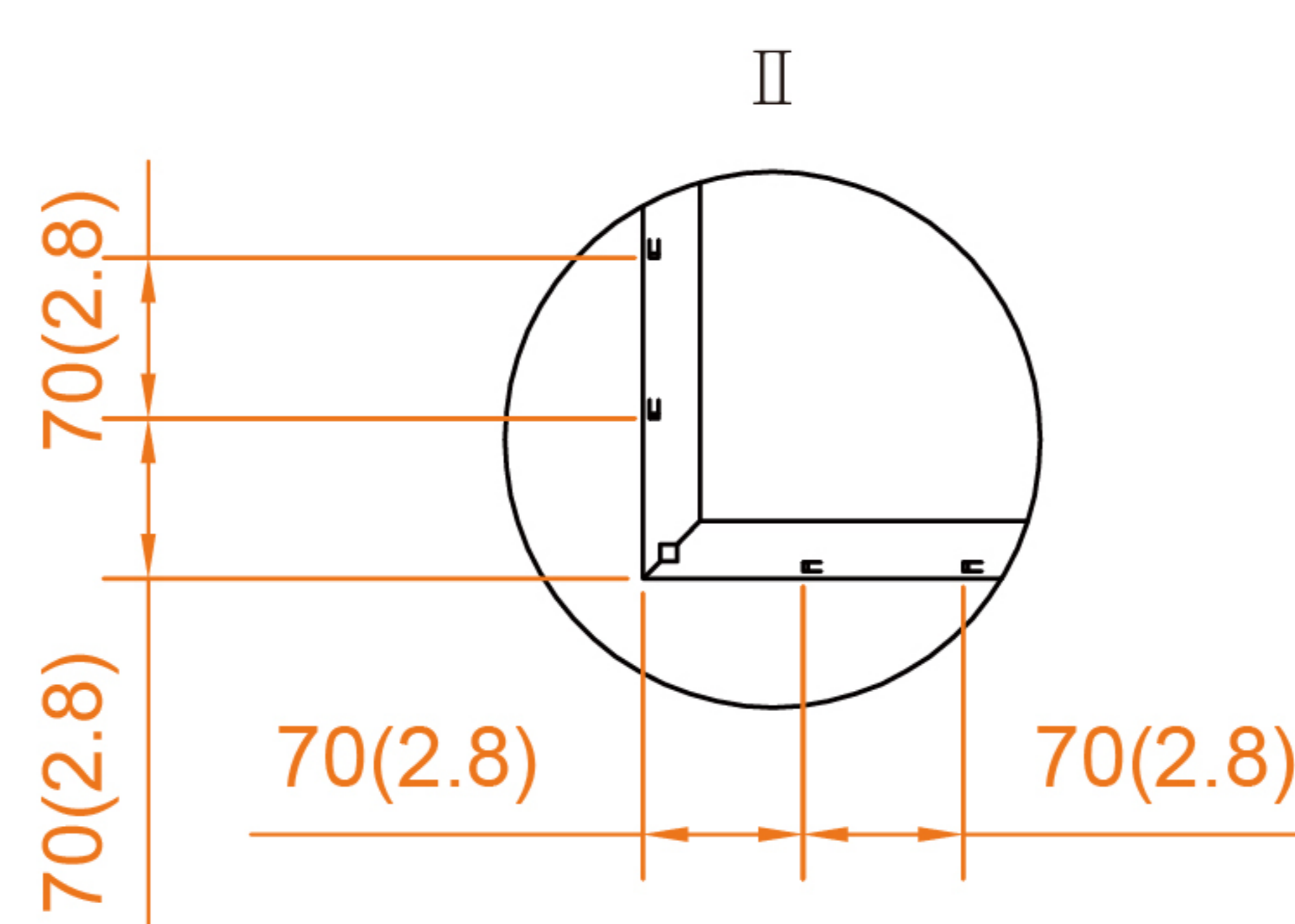
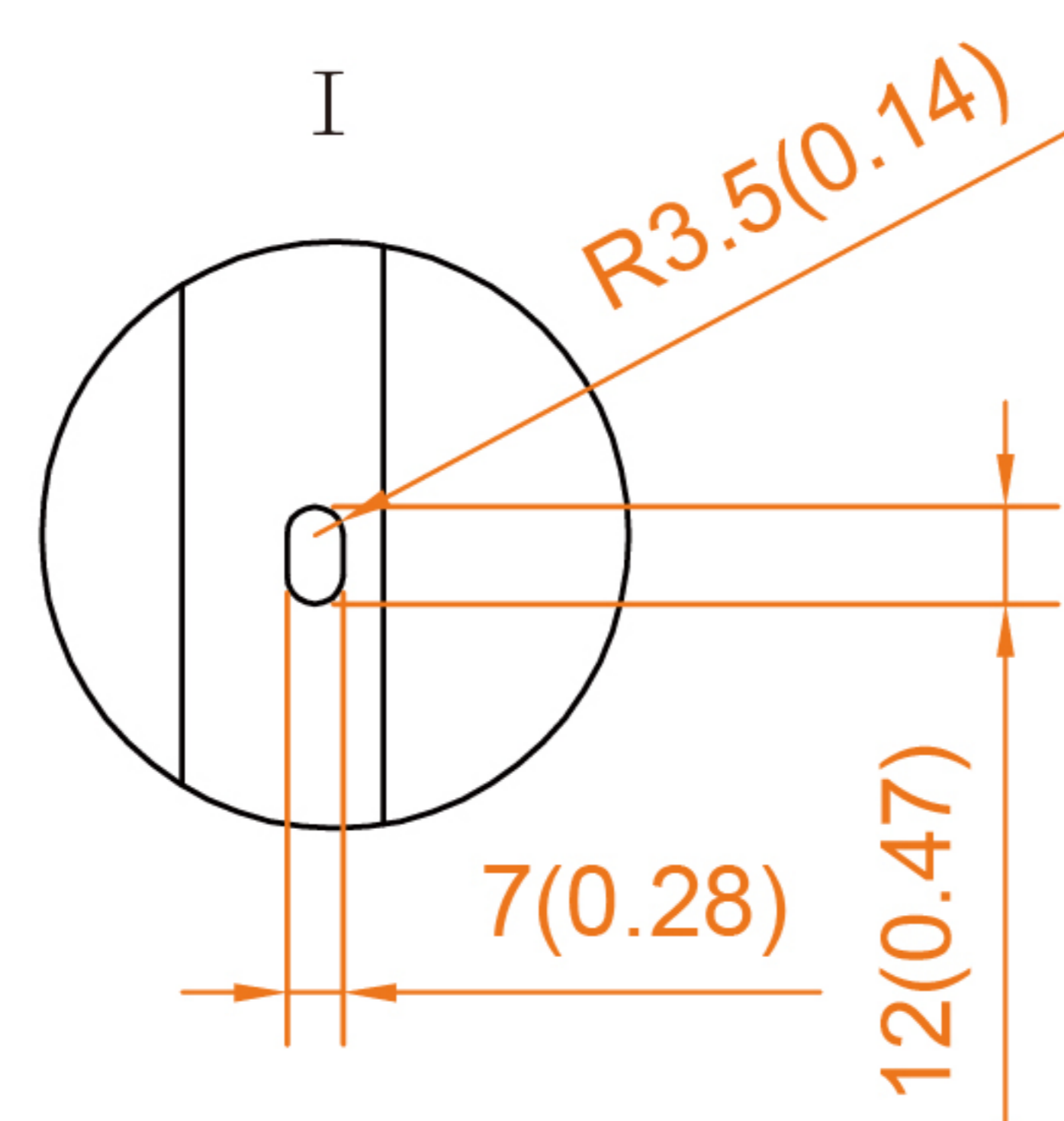
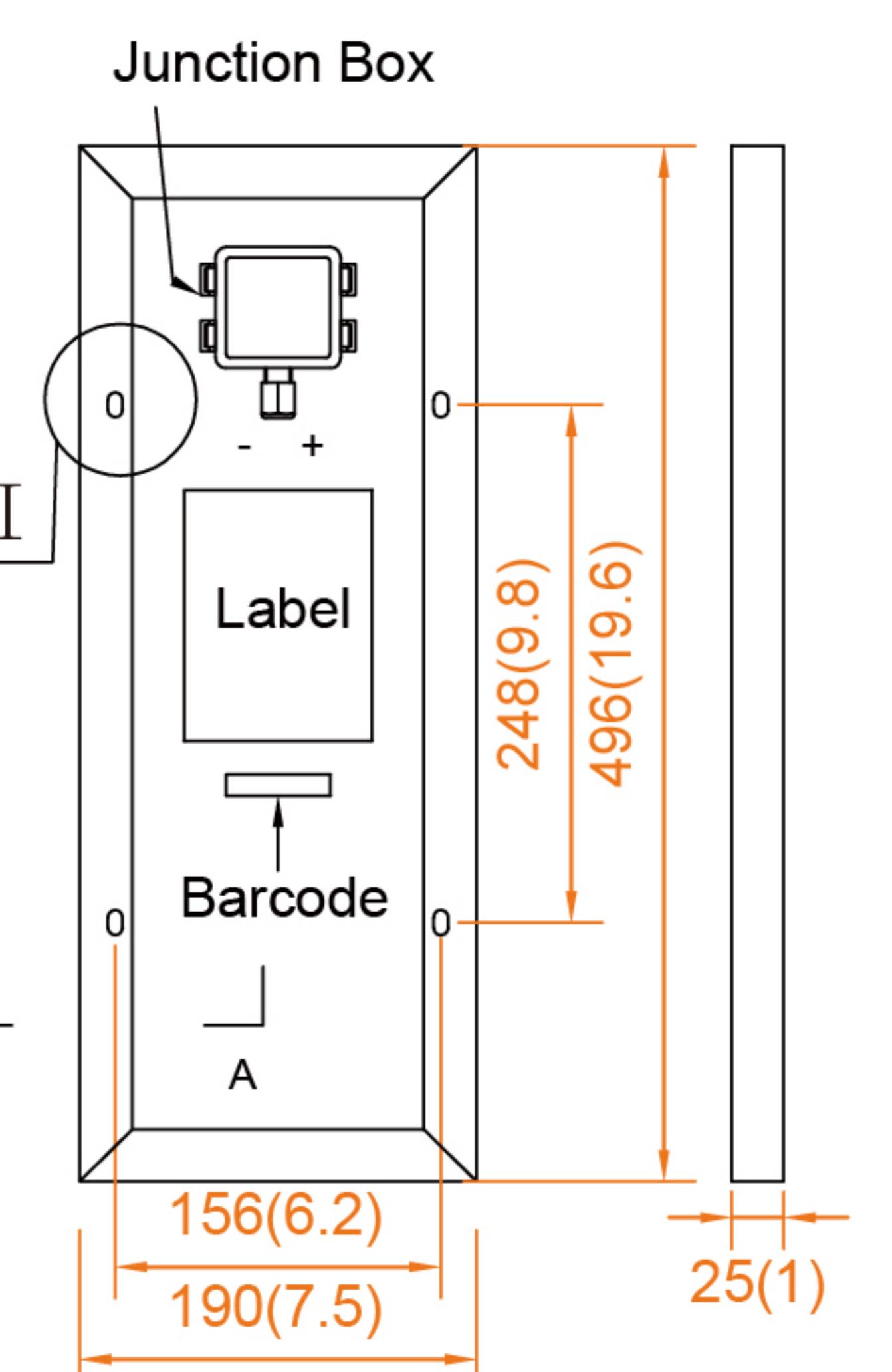

Section:A-A

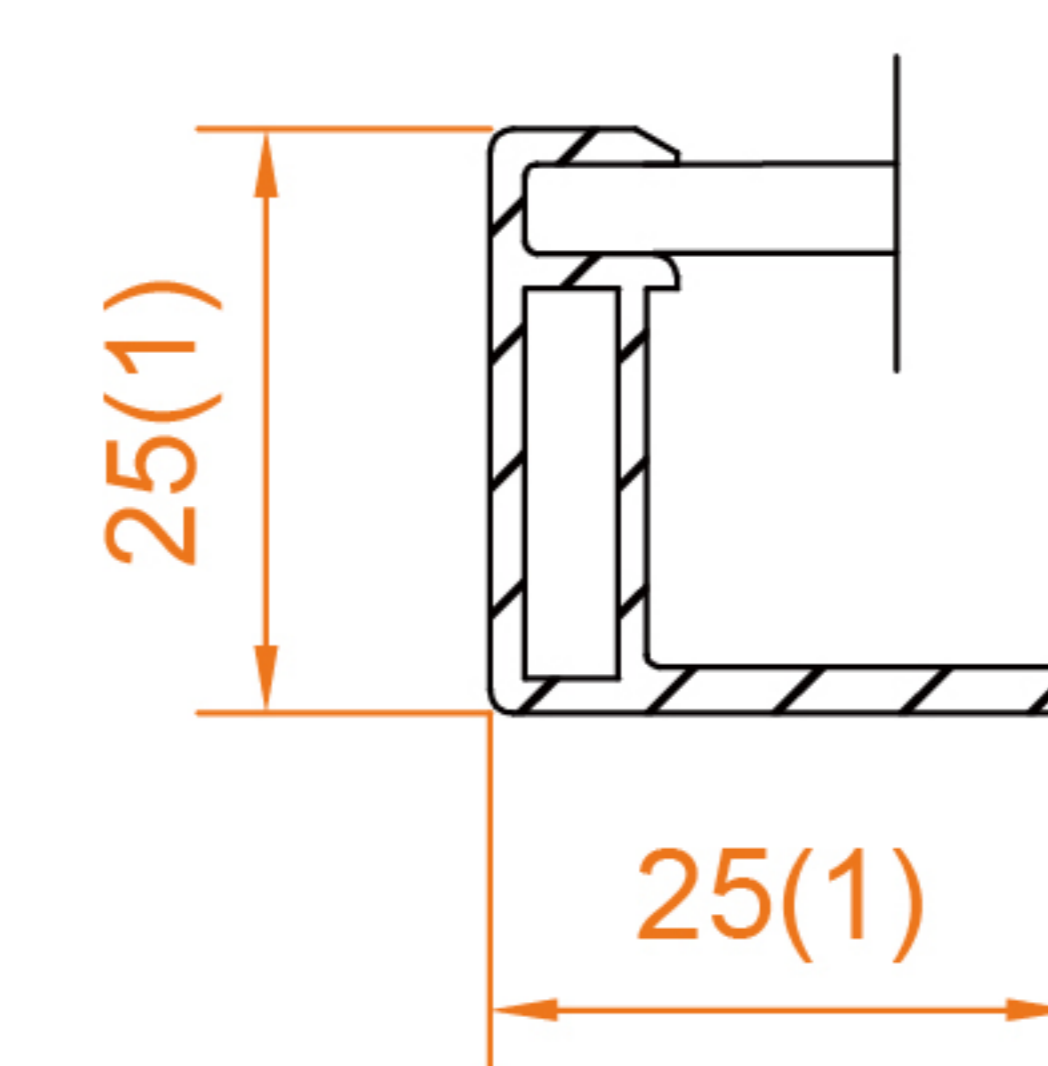
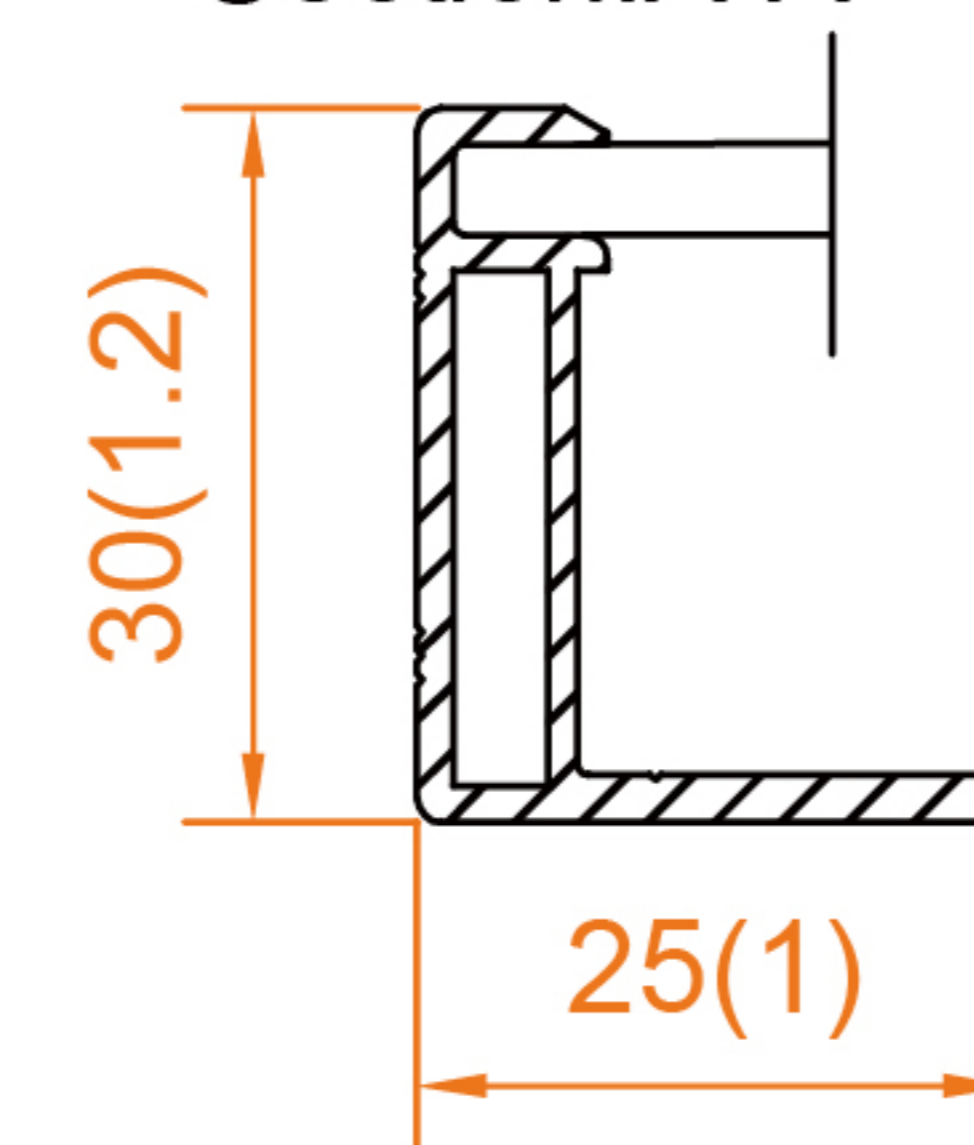

MANAGEMENT SYSTEM

- ISO 9001: Quality management system
- ISO 14001: Standard for environmental management system
- OHSAS 18001: International standard for occupational health and safety assessment system

*All Dimensions in mm(inch)

*The above drawing is a graphical representation of the product.

For engineering quality drawings please contact SUNKET.

PRODUCT CERTIFICATES



Specifications are subject to change without further notification SKT-EN-2019V1.0 © Copyright 2019 Sunket

Electrical Characteristics (STC)

Module Type	SKT10M6-12	SKT20M6-12	SKT30M6-12	SKT35M6-12	SKT40M6-12	SKT45M6-12
Maximum Power- Pmax(W)	10	20	30	35	40	45
Open Circuit Voltage - Voc(V)	22.1	22.1	22.6	22.1	22.8	22.2
Short- Circuit Current - Isc(A)	0.60	1.19	1.76	2.09	2.32	2.67
Voltage at Pmax -Vmp(V)	18.1	18.1	18.4	18.1	18.6	18.2
Current at Pmax - Imp(A)	0.55	1.10	1.63	1.93	2.15	2.47
Module Efficiency -ηm (%)	10.61	11.52	13.07	12.38	14.15	13.53

Module Type	SKT50M6-12	SKT55M6-12	SKT60M6-12	SKT65M6-12	SKT70M6-12	SKT75M6-12
Maximum Power- Pmax(W)	50	55	60	65	70	75
Open Circuit Voltage - Voc(V)	22.8	22.8	22.8	22.6	22.8	22.6
Short- Circuit Current - Isc(A)	2.90	3.19	3.48	3.82	4.06	4.40
Voltage at Pmax -Vmp(V)	18.6	18.6	18.6	18.4	18.6	18.4
Current at Pmax - Imp(A)	2.69	2.96	3.23	3.53	3.76	4.08
Module Efficiency -ηm (%)	15.04	15.40	15.04	15.04	16.19	14.65

STC: Irradiance 1000W/m², Cell Temperature 25 °C, Air Mass 1.5
Power measurement tolerance:0~+3%

Mechanical Specifications

Module Type	SKT70/75M6-12	SKT65M6-12	SKT50~60M6-12	SKT40/45M6-12
Dimensions	650×665×30mm	600×665×30mm	537×665×30mm	425×665×30mm
Weight	5.2kg	4.8kg	4.0kg	3.4kg
Mono Solar Cells	66×156mm (36pcs)	58.5×156mm (36pcs)	52×156mm (36pcs)	39×156mm (36pcs)

Module Type	SKT30/35M6-12	SKT20/25M6-12	SKT10M6-12
Dimensions	656×350×25mm	496×350×25mm	496×190×25mm
Weight	2.5kg	2.0kg	1.2kg
Mono Solar Cells	31.2×156mm (36pcs)	22.28×156mm (36pcs)	22.28×78mm (36pcs)

Front glass	3.2 mm low iron tempered glass	Frame	Anodized aluminum alloy.
Junction Box	IP67	Mechanical Load	5400 Pa

Packing Configuration

Module Type	SKT70/75M6-12	SKT65M6-12	SKT50~60M6-12	SKT40/45M6-12
Carton Dimensions	665×680×175mm	615×680×175mm	552×680×175mm	515×680×175mm
Pallet Dimensions	1370×1100×2170mm	1270×1100×2170mm	1400×1130×2170mm	1400×1100×2190mm
Pallet Weight	1012.8kg	940.8kg	1110kg	1038kg
Pieces/Pallet	180(5pcs/carton)	180(5pcs/carton)	240(5pcs/carton)	240(5pcs/carton)

Module Type	SKT30/35M6-12	SKT20/25M6-12	SKT10M6-12
Carton Dimensions	440×680×175mm	670×280×365mm	510×390×365mm
Pallet Dimensions	1360×1100×2170mm	1370×1150×1960mm	1600×1050×1960mm
Pallet Weight	996.6kg	1070kg	1190kg
Pieces/Pallet	270(5pcs/carton)	400(10pcs/carton)	560(14pcs/carton)

I-V Curve (SKT50M6-12)

