

**For a Free Quote:**

Web: **EnergyPal.com/solar**

Call: **1-800-990-3725**

Email: **contact@energypal.com**

# **EnergyPal**

## **Solar Panel Guide Specification Data Sheet**

**Sri Raghavendra Engineering Works**

**SR-P310-350W-EW**

**SR-315-EW**

Also available on the web at

[EnergyPal.com/sri-raghavendra-engineering-works-solar-panels/sr-315-ew](http://EnergyPal.com/sri-raghavendra-engineering-works-solar-panels/sr-315-ew)

# Data Sheet

SR-310-EW, SR-325-EW, SR-350-EW poly solar panel

## Specifications

Dimension (L X W X T)	number of cells	Cell size	Weight
1966 X 990 X 35 H	72 PCS	polycrystalline	21.5 kgs
		156.75 X 156.75 X 0.2MM	

## Characteristics

Model No	SR-310-EW	SR-315-EW	SR-325-EW	SR-350-EW
Peak power (W)	310±3%	315±3%	325±3%	350±3%
Open circuit voltage (V)	45.3	45.5	45.5	47
Short circuit current (A)	9.09	9.11	9.25	9.47
Max. Power voltage (V)	36.5	37	37	38.6
Max. Power current (A)	8.49	8.51	8.64	9.06

STC: Irradiance 1000W/ m<sup>2</sup>, Cell temperature 25° C, AM 1.5

## Temperature and coefficient

NOCT	48±2°C	Limits	
Coefficient current TK	0.1%/ °C	Operating temperature limits	-40°C to +85°C
Coefficient voltage TK	-0.37%/°C	Max.system voltage (V)	1500 VDC
Coefficient power TK	-0.45%/°C		

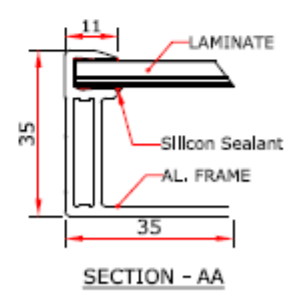
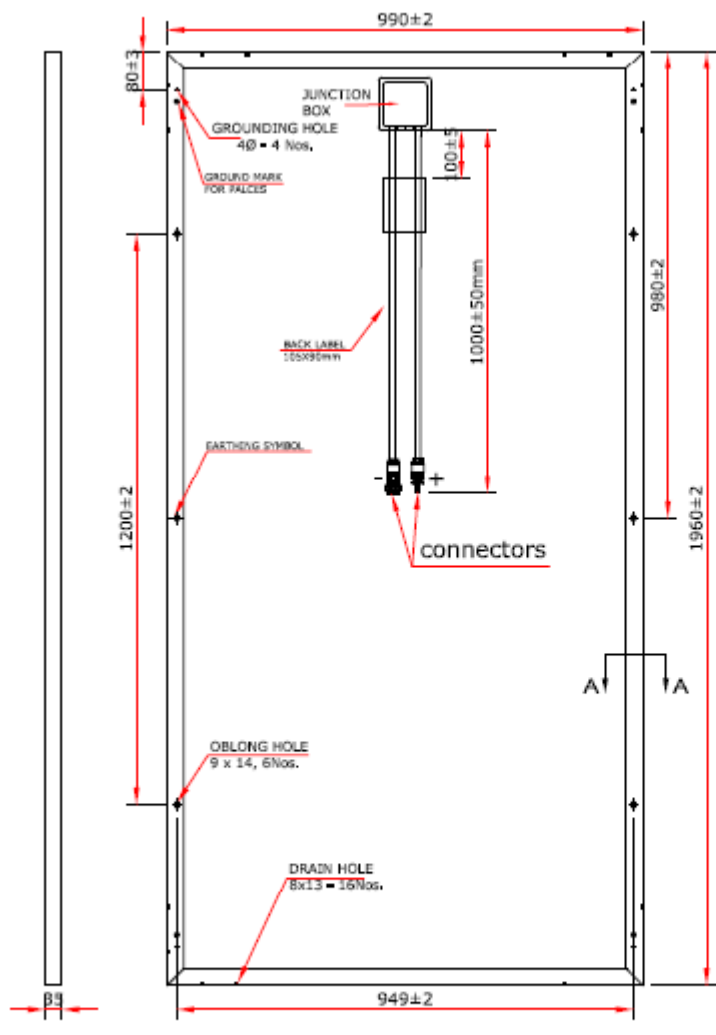

SRI RAGHAVENDRA ENGINEERING WORKS  
 PLOT NO 13E/12, PHASE-1, KIADB INDUSTRIAL AREA  
 KUMBALAGODU, MYSORE ROAD, BANGALORE-560074