

For a Free Quote:

Web: EnergyPal.com/solar

Call: 1-800-990-3725

Email: contact@energypal.com

EnergyPal

Solar Panel Guide Specification Data Sheet

Znshine PV-tech Co., Ltd.

ZXM6-60

ZXM6-60-285/M

Also available on the web at
EnergyPal.com/znshine-pv-tech-co-ltd-solar-panels/zxm6-60-285-m

ZXM6-60 Series

Znshinesolar 5BB Monocrystalline PV Module

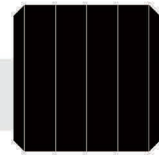

Mono Poly Solutions

280W | 285W | 290W | 295W | 300W | 305W | 310W

Made with selected materials and components to grant quality, duration, efficiency and through outputs, the ZXM6-60 monocrystalline modules by ZNSHINE SOLAR represent a highly flexible solution for diverse installation types, from industrial rooftop plants to small home PV systems or large ground surfaces. This allows you to produce clean energy whilst reducing your energy bill.

ZNSHINE SOLAR' S ZXM6-60 monocrystalline solar modules are tested and approved by international acknowledged laboratories, so that we can offer our customers a reliable and price-quality optimized product. The linear warranty on product outputs further ensures increased security and return on investments over time.

12 years product warranty for general application

15 years product warranty for Rooftop PV system

25 years output warranty/0.55% linear degradation p.a.

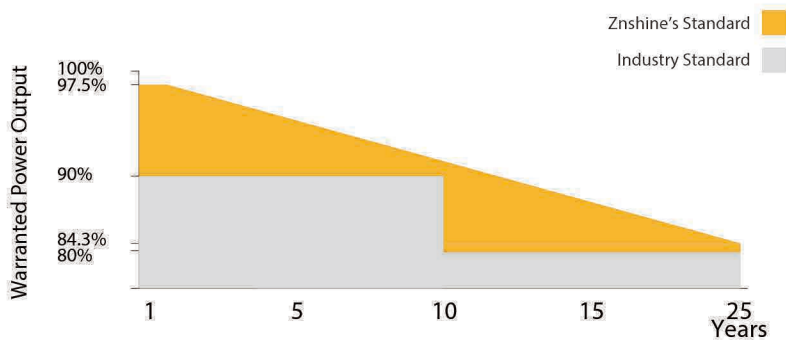

<p>5 Busbar Solar Cell</p> <p>No power loss thanks to improved temperature co-efficient caused by 5 busbar solar cell</p>	<p>Easy to install</p> <p>The module is very light in weight so the installation is easier and transport costs are lower</p>
<p>Anti PID (Optional)</p> <p>Limited power degradation of ZXM6-60 module caused by PID effect is guaranteed under strict testing condition for mass production</p>	<p>Linear Warranty</p> <p>25-year linear warranty on outputs</p>



ELECTRICAL PROPERTIES | STC*

Module Type	ZXM6-60-280/M	ZXM6-60-285/M	ZXM6-60-290/M	ZXM6-60-295/M	ZXM6-60-300/M	ZXM6-60-305/M	ZXM6-60-310/M
Nominal Power Watt Pmax(W)	280	285	290	295	300	305	310
Power Output Tolerance Pmax(%)	±3	±3	±3	±3	±3	±3	±3
Maximum Power Voltage Vmp(V)	31.6	31.8	32.0	32.2	32.4	32.7	32.9
Maximum Power Current Imp(A)	8.87	8.97	9.07	9.17	9.26	9.33	9.43
Open Circuit Voltage Voc(V)	38.9	39.1	39.3	39.5	39.7	39.9	40.1
Short Circuit Current Isc(A)	9.37	9.47	9.56	9.67	9.75	9.85	9.95
Module Efficiency (%)	17.11	17.41	17.72	18.02	18.33	18.63	18.94

*STC (Standard Test Condition): Irradiance 1000W/m², Module Temperature 25°C, AM 1.5
 *The data above is for reference only and the actual data is in accordance with the practical testing

ELECTRICAL PROPERTIES | NOCT*

Maximum Power Pmax(Wp)	207.4	211.3	214.5	219	222.3	225.8	229.3
Maximum Power Voltage Vmpp(V)	29.3	29.7	29.7	29.8	30.2	30.4	30.6
Maximum Power Current Impp(A)	7.08	7.12	7.23	7.34	7.36	7.42	7.49
Open Circuit Voltage Voc(V)	36.0	36.2	36.4	36.6	36.7	36.9	37.1
Short Circuit Current Isc(A)	7.57	7.57	7.72	7.81	7.81	7.88	7.96

*NOCT (Nominal Operating Cell Temperature): Irradiance 800W/m², Ambient Temperature 20°C, AM 1.5, Wind Speed 1m/s
 *The data above is for reference only and the actual data is in accordance with the practical testing

TEMPERATURE RATINGS

NOTC	45°C ± 2°C
Temperature coefficient of Pmax	-0.37%/°C
Temperature coefficient of Voc	-0.29%/°C
Temperature coefficient of Isc	0.05%/°C

*Do not connect Fuse in Combiner Box with two or more strings in parallel connection

MECHANICAL DATA

Solar cells	5BB Mono 156.75×156.75 mm
Cells orientation	60 (6×10)
Module dimension	1650×992×40 mm
Weight	19 kg
Glass	High transparency, low iron, tempered 3.2mm Coated glass
Junction box	IP 68, 3 diodes
Cables	H1Z2Z2-K 1×4,0mm ²
Connectors	LJQ-1 manufactured in China

WORKING CONDITIONS

Maximum system voltage	1500 V DC
Operating temperature	-40°C ~ +85°C
Maximum series fuse	15 A
Maximum load front/back	3600/1600 for 8 M8 screws 2400/2400 only for 4 clamps with 40mm frame with safety factor 1.5

PACKAGING INFORMATION

Packing Type	40' HQ
Piece/Box	27
Piece/Container	756

DIMENSION OF THE PV MODULE (mm)

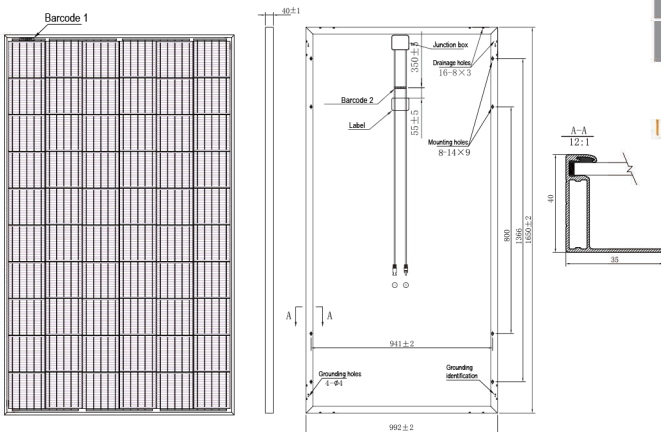

I-V CURVES OF THE PV MODULE

